



DriveGuard 
**Safe Torque Off Option for
PowerFlex 700S Phase II AC Drives and PowerFlex
700L Liquid-Cooled AC Drives**

Catalog Number 20D-P2-DG01



Allen-Bradley

by ROCKWELL AUTOMATION

User Manual

Original Instructions

Important User Information

Read this document and the documents listed in the additional resources section about installation, configuration, and operation of this equipment before you install, configure, operate, or maintain this product. Users are required to familiarize themselves with installation and wiring instructions in addition to requirements of all applicable codes, laws, and standards.

Activities including installation, adjustments, putting into service, use, assembly, disassembly, and maintenance are required to be carried out by suitably trained personnel in accordance with applicable code of practice.

If this equipment is used in a manner not specified by the manufacturer, the protection provided by the equipment may be impaired.

In no event will Rockwell Automation, Inc. be responsible or liable for indirect or consequential damages resulting from the use or application of this equipment.

The examples and diagrams in this manual are included solely for illustrative purposes. Because of the many variables and requirements associated with any particular installation, Rockwell Automation, Inc. cannot assume responsibility or liability for actual use based on the examples and diagrams.

No patent liability is assumed by Rockwell Automation, Inc. with respect to use of information, circuits, equipment, or software described in this manual.

Reproduction of the contents of this manual, in whole or in part, without written permission of Rockwell Automation, Inc., is prohibited.

Throughout this manual, when necessary, we use notes to make you aware of safety considerations. Labels may also be on or inside the equipment to provide specific precautions.



WARNING: Identifies information about practices or circumstances that can cause an explosion in a hazardous environment, which may lead to personal injury or death, property damage, or economic loss.



ATTENTION: Identifies information about practices or circumstances that can lead to personal injury or death, property damage, or economic loss. Attentions help you identify a hazard, avoid a hazard, and recognize the consequence.

IMPORTANT

Identifies information that is critical for successful application and understanding of the product.



SHOCK HAZARD: Labels may be on or inside the equipment, for example, a drive or motor, to alert people that dangerous voltage may be present.



BURN HAZARD: Labels may be on or inside the equipment, for example, a drive or motor, to alert people that surfaces may reach dangerous temperatures.



ARC FLASH HAZARD: Labels may be on or inside the equipment, for example, a motor control center, to alert people to potential Arc Flash. Arc Flash will cause severe injury or death. Wear proper Personal Protective Equipment (PPE). Follow ALL Regulatory requirements for safe work practices and for Personal Protective Equipment (PPE).

Table of Contents

Summary of Changes	New and Updated Information.....	5
Chapter 1	General Description	
	What Is the DriveGuard Safe Torque Off Option?	7
	Safety of Machinery Standards	8
	Safety Certifications	9
	Functional Safety Evaluation	9
	Certifications Online	9
	Important Safety Considerations	10
	Safety Category 3 Performance Definition	11
	Stop Category Definitions	11
	Performance Level and Safety Integrity Level (SIL) CL2	12
	PFDavg and PFH Definitions	12
	PFDavg and PFH Data	12
	PFDavg and PFH for 20-year Proof Test Interval	13
	Functional Proof Tests	13
	Contact Information if Safety Option Failure Occurs	13
Chapter 2	Installation and Wiring	
	Pre-Installation Instructions	15
	Option Board Installation	16
	PowerFlex 700S Frames 1...6 and PowerFlex 700L Frames 2, 3A, and 3B	16
	PowerFlex 700S Frames 9...14	17
	PowerFlex 700S, All Frames, and PowerFlex 700L, All Frames 18	18
	PowerFlex 700S Frames 1...6	23
	PowerFlex 700S Frames 9...14	23
	PowerFlex 700L Frames 3A and 3B	24
	Wiring	25
	Configure Hardware Enable	26
	Configure Digital Outputs	27
	Linking Parameters	27
	Verify Operations	28
Chapter 3	Description of Operation	
	DriveGuard Safe Torque Off Operation	29
	Connection Examples	31
	Operating Principle	34
Index	35

Notes:

Summary of Changes

This manual contains new and updated information.

New and Updated Information

The following changes apply to this revision of the manual.

Change	See Page...
Added UKCA certification and changed TUV Rheinland to Functional Safety.	Throughout

Summary of Changes

Notes:

General Description

The DriveGuard® Safe Torque Off option, when used with other safety components, helps provide protection to meet the requirements for SIL CL2 and Category 3 or PL (d) class applications. Safety requirements are based on the standards current at the time of certification.

The DriveGuard Safe Torque Off option is just one component in a safety control system. Components in the system must be chosen and applied appropriately to achieve the desired level of operator safeguarding.

What Is the DriveGuard Safe Torque Off Option?

The DriveGuard Safe Torque Off option:

- Is designed to help safely remove power from the gate firing circuits of the drive's output power devices (IGBTs). This helps prevent the drive's output power devices from switching in the pattern necessary to generate rotation at the motor.
- Can be used in combination with other safety devices to satisfy the Safe Torque Off requirements of SIL CL2, according to EN 61800-5-2, IEC 61508, and EN 62061 Performance Level PL (d) and Category 3 according to EN ISO 13849-1.



TIP: PowerFlex® 700L drives using 700S control with Safe Torque Off manufactured before 09/25/2020, are TUV certified.

IMPORTANT

This option is suitable for performing mechanical work on the drive system or affected area of a machine only. It does not provide electrical safety. For electrical maintenance on the drive and/or motor, equipment must be electrically disconnected from the power source.

The Safe Torque Off option should not be used for non safety-related stopping of the drive.



ATTENTION: Electrical Shock Hazard. Verify that all sources of AC and DC power are de-energized and locked out or tagged out in accordance with the requirements of ANSI/NFPA 70E, Part II.



ATTENTION: To avoid an electric shock hazard, verify that the voltage on the bus capacitors has discharged before performing any work on the drive. Measure the DC bus voltage at the +DC and -DC terminals or test points (refer to your drive's *User Manual* for locations). The voltage must be zero.



ATTENTION: In Safe Torque Off mode, hazardous voltages can still be present at the motor. To avoid an electric shock hazard, disconnect power to the motor and verify that the voltage is zero before performing any work on the motor.



ATTENTION: In the event of the failure of two output IGBTs in the drive, when the DriveGuard Safe Torque Off option has controlled the drive outputs to the off state, the drive can provide energy for up to 180° of rotation in a 2-pole motor before torque production in the motor ceases.

Safety of Machinery Standards

The DriveGuard Safe Torque Off option meets the Machinery Directive 2006/42/EC and the UK Machinery Regulations 2008 No. 1597 and the requirements of the following machine safety standards:

EN 61800-5-2 Adjustable Speed Electrical Power Drives Systems – Part 5-2 Safety Requirements: Functional

- EN ISO 13849-1 Safety of Machinery – Safety-related parts of control systems - Part 1: General Principles for Design
- EN 62061 + A1 Safety of Machinery, Functional safety of safety-related electrical, electronic and programmable electronic control systems
- EN 60204-1 + A1 Safety of Machinery – Electrical equipment of machines – Part 1: General Requirements
- IEC 61508 Part 1-7 Functional safety of electrical / electronic / programmable electronic safety-related systems

TIP: PowerFlex 700L drives using 700S control with Safe Torque Off manufactured before 09/25/2020, are TUV certified.

Safety Certifications

The DriveGuard Safe Torque Off option for use in safety-related applications where the de-energized state is considered to be the safe state. All of the examples related to I/O included in this manual are based on achieving de-energization as the safe state for typical Machine Safety and Emergency Shutdown (ESD) systems.

Functional Safety Evaluation

Drive	Rating ⁽²⁾
PowerFlex 700S Phase II	Frames 1...6 208/240V and 400/480V Frames 5 and 6 600/690V Frames 9...14 400/480V and 600/690V
PowerFlex 700L Liquid-Cooled ⁽¹⁾	Frames 2, 3A, and 3B 400/480V and 600/690V

(1) PowerFlex 700L drives using 700S control with Safe Torque Off manufactured before 09/25/2020, are TUV certified.

(2) All voltages are listed in AC, these values are also relevant to their corresponding DC input voltage ratings.

Certifications Online

CE/UK Declarations of Conformity, Certificates, and other certifications details are available online at the Product Certifications website, <https://rok.auto/certifications>.

Important Safety Considerations

The system user is responsible for:

- the set-up, safety rating, and validation of any sensors or actuators connected to the system.
- completing a system-level risk assessment and reassessing the system any time a change is made.
- certification of the system to the desired safety performance level.
- project management and proof testing.
- programming the application software and the safety option configurations in accordance with the information in this manual.
- access control to the system, including password handling.
- analyzing all configuration settings and choosing the proper setting to achieve the required safety rating.
- in circumstances where external influences (for example falling or suspended loads) are present, additional measures (for example mechanical brakes) can be necessary to prevent any hazard.

IMPORTANT When applying Functional Safety, restrict access to qualified, authorized personnel who are trained and experienced.



ATTENTION: When designing your system, consider how personnel will exit the machine if the door locks while they are in the machine. Additional safeguarding devices can be required for your specific application.

Safety Category 3 Performance Definition

To achieve Safety Category 3 according to EN ISO 13849-1, the safety-related parts have to be designed such that:

- the safety-related parts of machine control systems and/or their protective equipment, as well as their components, shall be designed, constructed, selected, assembled, and combined in accordance with relevant standards so that they can withstand expected conditions.
- basic and well-tried safety principles shall be applied.
- a single fault in any of its parts does not lead to a loss of safety function.
- some but not all faults will be detected.
- the accumulation of undetected faults can lead to loss of safety function.
- short circuits in the external wiring of the safety inputs is not one of the faults that can be detected by the system, therefore, according to DIN EN ISO 13849-2, these cables must be installed so as to be protected against external damage by cable ducting or armor.

Stop Category Definitions

The selection of a stop category for each stop function must be determined by a risk assessment.

- Stop Category 0 is achieved with immediate removal of power to the actuator, resulting in an uncontrolled coast to stop. See “Description of Operation” Example 1 on [page 31](#) and Example 2 on [page 32](#).
- Stop Category 1 is achieved with power available to the machine actuators to achieve the stop. Power is removed from the actuators when the stop is achieved. See “Description of Operation” Example 3 on [page 33](#).



TIP: PowerFlex 700L drives using 700S control with Safe Torque Off manufactured before 09/25/2020, are TUV certified.

IMPORTANT

When designing the machine application, timing and distance should be considered for a coast to stop (Stop Category 0 or Safe Torque Off). For more information regarding stop categories, refer to EN 60204-1.

Performance Level and Safety Integrity Level (SIL) CL2

For safety-related control systems, Performance Level (PL), according to EN ISO 13849-1, and SIL levels, according to IEC 61508 and EN 62061, include a rating of the system's ability to perform its safety functions. All of the safety-related components of the control system must be included in both a risk assessment and the determination of the achieved levels.

Refer to the EN ISO 13849-1, IEC 61508, and EN 62061 standards for complete information on requirements for PL and SIL determination.

PFDavg and PFH Definitions

Safety-related systems can be classified as operating in either a Low Demand mode, or in a High Demand/Continuous mode.

- Low Demand mode: where the frequency of demands for operation made on a safety-related system is no greater than one per year or no greater than twice the proof-test frequency.
- High Demand/Continuous mode: where the frequency of demands for operation made on a safety-related system is greater than once per year or greater than twice the proof test interval.

The SIL value for a Low Demand safety-related system is directly related to order-of-magnitude ranges of its average probability of failure to satisfactorily perform its safety function on demand or, simply, average probability of failure on demand (PFDavg). The SIL value for a High Demand/Continuous mode safety-related system is directly related to the average frequency of a dangerous failure per hour (PFH).

PFDavg and PFH Data

These PFDavg and PFH calculations are based on the equations from Part 6 of IEC 61508 and show worst-case values.

This table provides data for a 20-year proof test interval and demonstrates the worst-case effect of various configuration changes on the data.

PFDavg and PFH for 20-year Proof Test Interval

Attribute	Test Result Frames 1...6	Test Result Frames 9...14
PFDavg	5.28×10^{-5}	2.14×10^{-4}
PFH	6.00×10^{-10} 1/h (calculated according to IEC 61508)	2.64×10^{-9} 1/h (calculated according to IEC 61508)
MTTF _D	High (4023 years)	High (11415 years)
DC _{av}	low (69%)	low (80%)

Functional Proof Tests

The functional safety standards require that functional proof tests be performed on the equipment used in the system. Proof tests are performed at user-defined intervals and are dependent upon PFDavg and PFH values.

See [Verify Operations](#) on [page 28](#) for additional information.

IMPORTANT Your specific application determines the time frame for the proof test interval.

Contact Information if Safety Option Failure Occurs

If you experience a failure with any safety-certified device, contact your local Rockwell Automation distributor. With this contact, you can:

- return the device to Rockwell Automation so the failure is appropriately logged for the catalog number affected and a record is made of the failure.
- request a failure analysis (if necessary) to determine the probable cause of the failure.

Notes:

Installation and Wiring

Care should be taken to follow drive instructions for EMC and environmental compliance. Refer to the following list of manuals for specific instructions:



TIP: PowerFlex® 700L drives using 700S control with Safe Torque Off manufactured before 09/25/2020, are TUV certified.

- PowerFlex 700L Liquid-Cooled Adjustable Frequency AC Drive, publication [20L-UM001](#)
- PowerFlex 700S Adjustable Frequency Drive - Phase II Control, Frames 1...6, publication [20D-IN024](#)
- PowerFlex 700H Adjustable Frequency AC Drive and PowerFlex 700S High Performance AC Drive, Frames 9...14, publication [PFLEX-IN006](#)

Pre-Installation Instructions

Installation must be in accordance with the following steps and must be carried out by competent personnel. The DriveGuard® Safe Torque Off option is intended to be part of the safety related control system of a machine. Before installation, a risk assessment should be performed that compares the DriveGuard Safe Torque Off option specifications and all foreseeable operational and environmental characteristics of the machine to which it is to be fitted.

A safety analysis of the machine section controlled by the drive is required to determine how often the safety function should be tested for proper operation during the life of the machine.



ATTENTION: The following information is merely a guide for proper installation. Rockwell Automation, Inc. cannot assume responsibility for the compliance or the noncompliance to any code, national, local or otherwise for the proper installation of this equipment. A hazard of personal injury and/or equipment damage exists if codes are ignored during installation.

Option Board Installation

PowerFlex 700S Frames 1..6 and PowerFlex 700L Frames 2, 3A, and 3B

1. Remove the I/O Control Cassette from the drive.

Task	Description
A	Open the door of the power structure and disconnect the cables that connect to the main board.
B	Loosen the screws on the face of the cassette.
C	Remove the cassette.

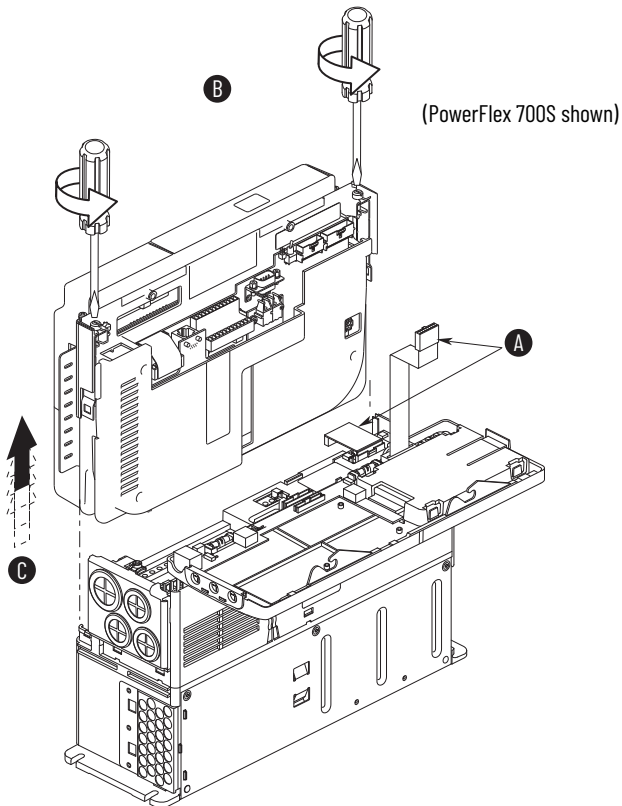

PowerFlex 700S Frames 9...14**I. Remove the I/O Control Cassette from the drive.**

Task	Description
A	Open the door of the power structure and carefully disconnect the three cables that connect to the main board.
B	Loosen the thumb screw that holds the metal flange in place.
C	Swing the flange and cassette away from the control frame.
D	Loosen the screws on the face of the cassette.
E	Remove the cassette.

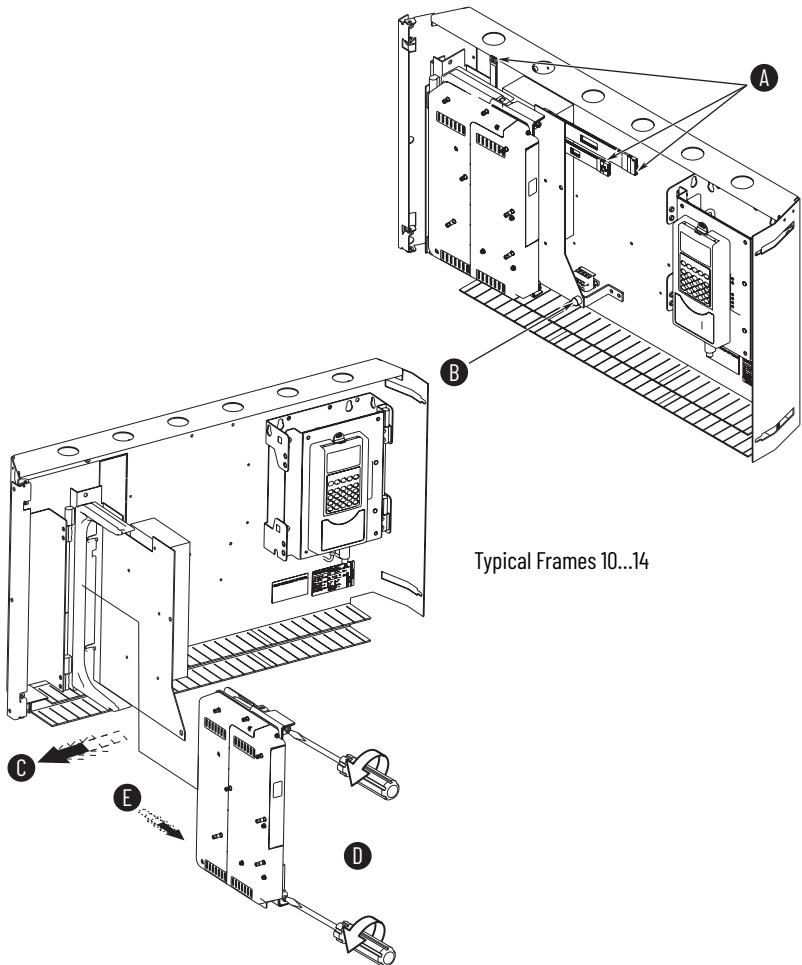

PowerFlex 700S, All Frames, and PowerFlex 700L, All Frames

2. Remove the screws securing the interior cassette cover to gain access to the Main board.

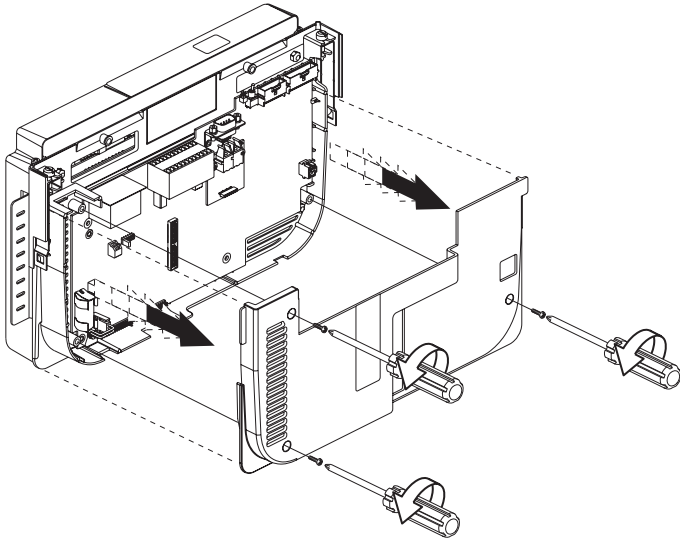

3. Remove the 2-pin shunt jumper from the 16-15 pin position.

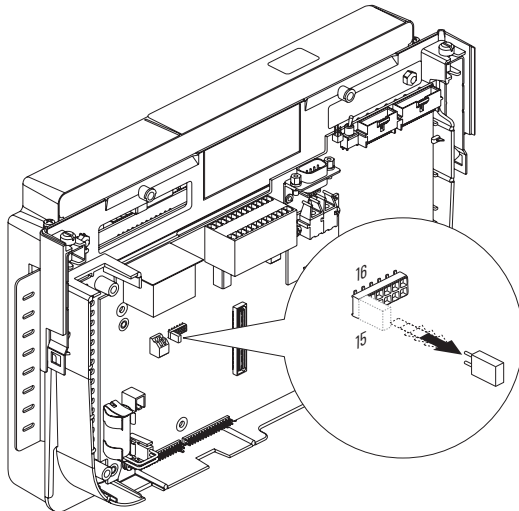

IMPORTANT

If the DriveGuard Safe Torque Off option is removed from the drive, this jumper must be reinstalled or the drive will not run.

4. Remove the exterior cassette covers to access the grounding plate.

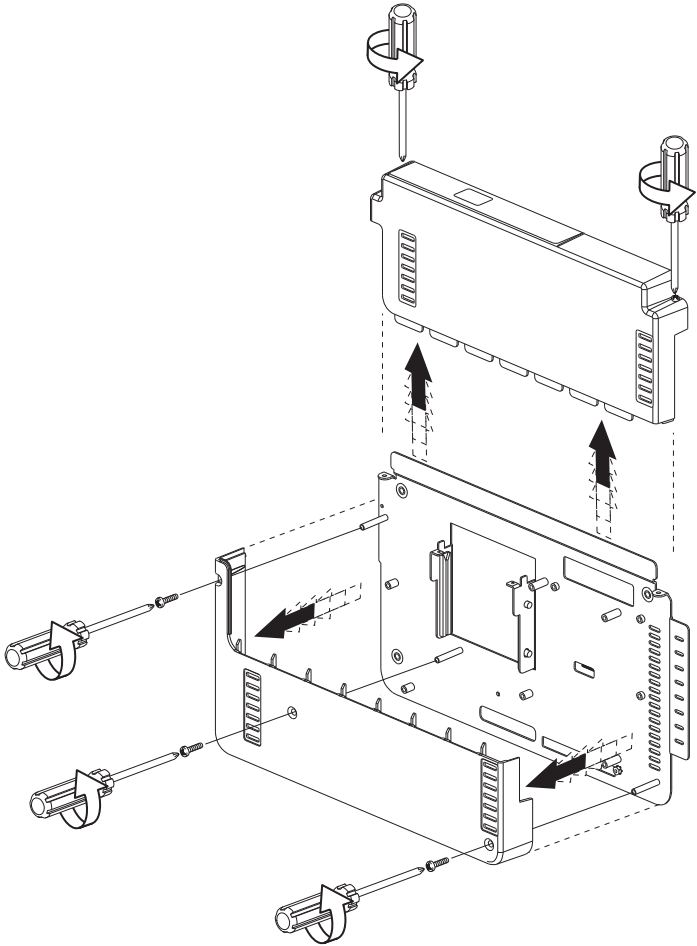

5. Install the 16-pin stacker connector.

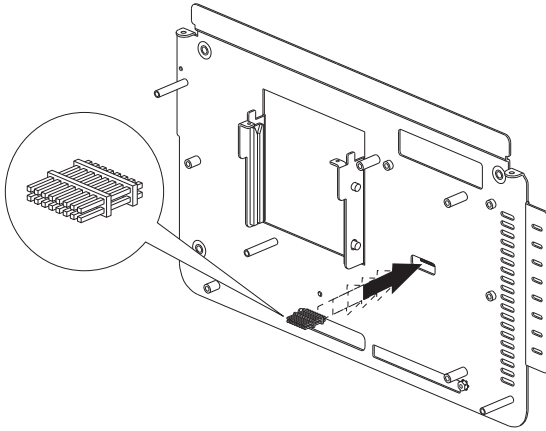

6. Plug the DriveGuard Safe Torque Off option into the 16-pin connector.

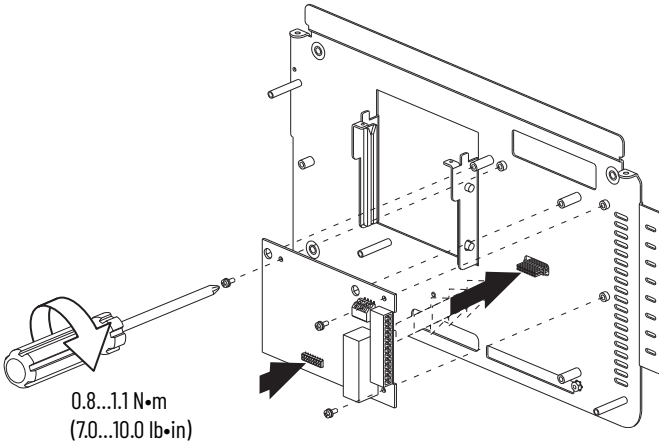

7. Install and tighten mounting screws.

8. Install the exterior cassette covers.

0.8...1.1 N•m
(7.0...10.0 lb•in)

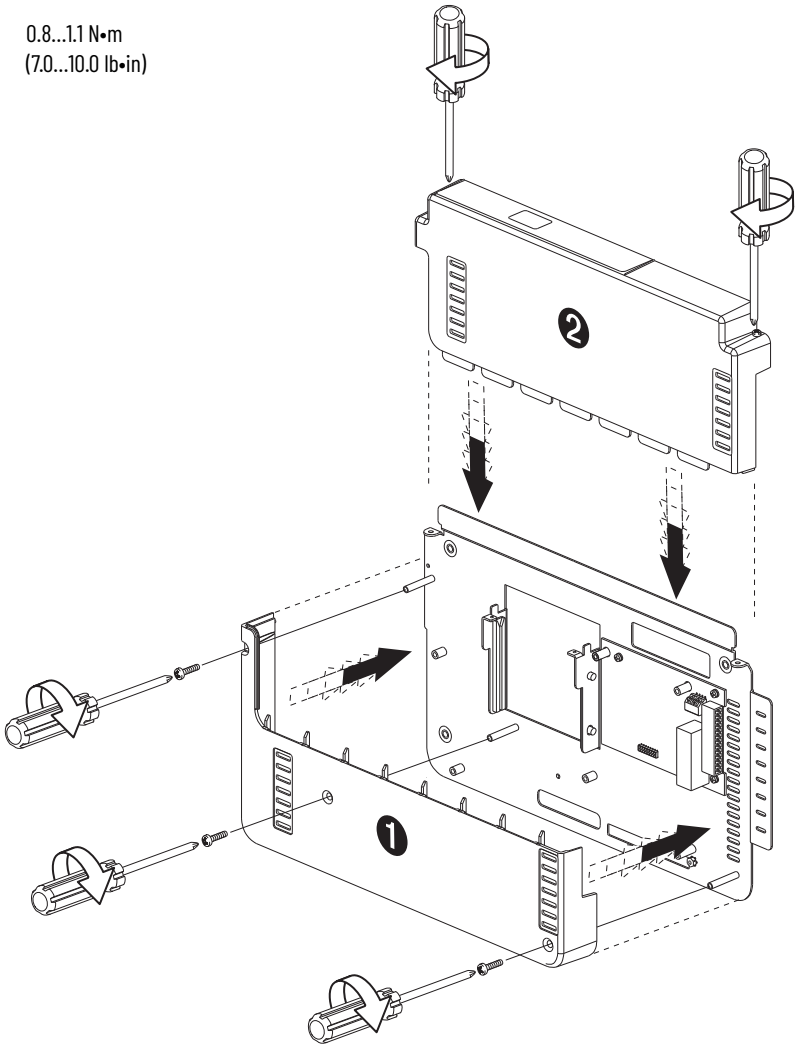

9. Install the inside front cover.

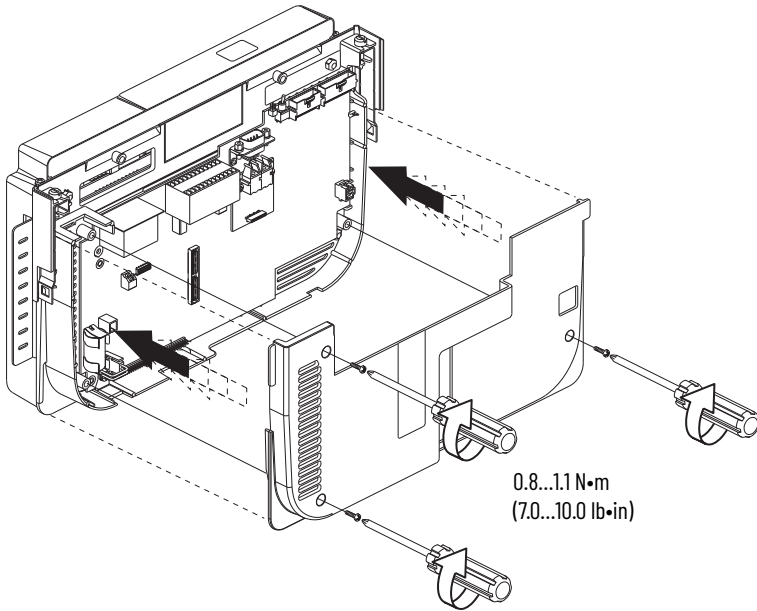

10. Reinstall the cassette in the drive.
11. Record the modification on the Field Installed Option label.

PowerFlex 700S Frames 1...6

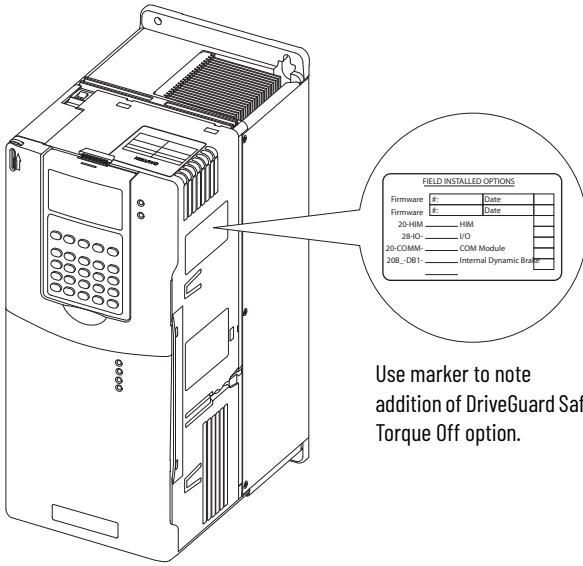

Use marker to note addition of DriveGuard Safe Torque Off option.

PowerFlex 700S Frames 9...14

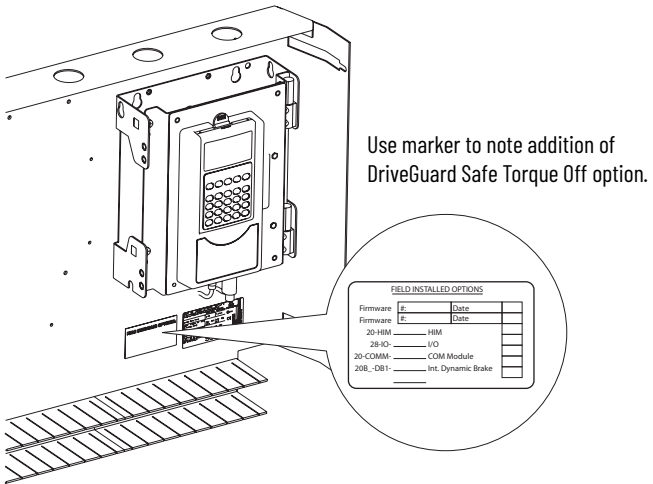

Use marker to note addition of DriveGuard Safe Torque Off option.

(Frame 10 shown)

PowerFlex 700L Frames 3A and 3B

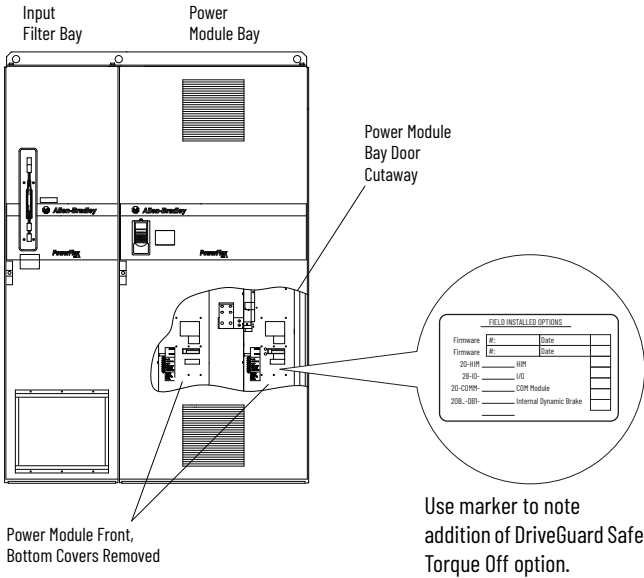

Wiring

Important points to remember about wiring:

- Always use tinned copper wire.
- Wire with an insulation rating of 600V or greater is recommended.
- Control wires should be separated from power wires by at least 0.3 meters (1 foot).
- All control wires should be shielded cable with the shield earthed on one end of the cable.

Table 1 - DriveGuard Safe Torque Off Option Terminal Block Specifications

Wire Size Range ⁽¹⁾		Torque	
Maximum	Minimum	Maximum	Recommended
1.5 mm ² (16 AWG)	0.14 mm ² (26 AWG)	0.25 N•m (2.2 lb•in)	0.22 N•m (1.9 lb•in)

(1) Maximum / minimum that the terminal block will accept - these are not recommendations.

Table 2 - Wire Types

Wire Type(s)		Description	Minimum Insulation Rating
Unshielded	Per US NEC or applicable national or local code	NOT RECOMMENDED	300V, 60 degrees C (140 degrees F)
Shielded	Multi-conductor shielded cable such as Belden 8770 (or equiv.)	0.750 mm ² (18AWG), 3 conductor, shielded.	

Table 3 - DriveGuard Safe Torque Off Option Terminals Description

No.	Signal	Description
1	+24V DC	Connections for user-supplied power to energize coil.
2	24V Common	33.3 mA typical, 55 mA maximum.
3	Monitor - N.C.	Normally closed contacts for monitoring relay status.
4	Common - N.C.	Maximum Resistive Load: 250V AC / 30V DC / 50 VA / 60 Watts Maximum Inductive Load: 250V AC / 30V DC / 25 VA / 30 Watts

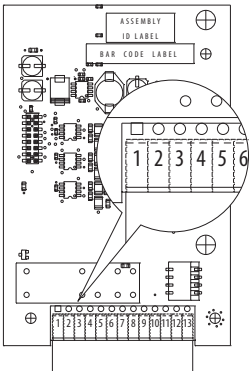

Configure Hardware Enable

Make sure that Jumper P22 on the Main Control Board is set to HW Enable (Pins 2 and 4).

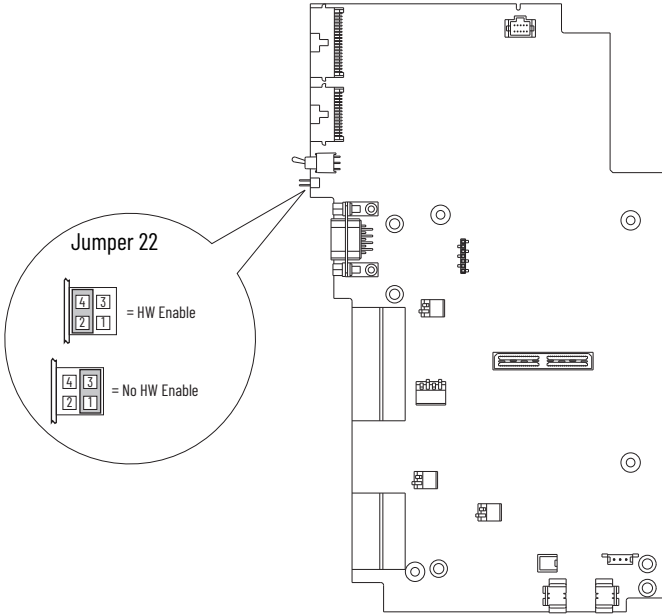

IMPORTANT

In addition to the correct jumper setting, enable circuitry must be connected to I/O Terminals 13 and 16. For wiring examples, refer to the following publications.

- PowerFlex 700S Phase II Drive Frames 1...6 Installation Instructions, publication [20D-IN024](#)
- PowerFlex 700H and 700S Drive Frames 9...14 Installation Instructions, publication [PFLEX-IN006](#)

Configure Digital Outputs

Digital Output 1 and 2 (TB2 Terminals 3, 4, and 5) and Relay Output 3 (TB2 Terminals 6, 7, and 8) can be configured to activate external logic in the event the safety enable diagnostic routine results in an F45 “Enable Health” fault.

The user must take care that a hazard cannot occur due to a failure of the digital output or the parameter link function. If external logic is desired to indicate that an Enable Health fault has occurred, follow these steps to configure the digital output.

1. Set Par 147 [FW Functions En], Bit 14 “Digital Outs” to 1 (True).
2. Set Par 845 [Dig Out1 Sel], Par 850 [Dig Out2 Sel] or Par 855 [Rly Out3 Sel] to option 0 “User Select”.
3. Link Par 846 [Dig Out1 Data], Par 851 [Dig Out2 Data] or Par 856 [Rly Out3 Data] to Par 324 [Fault Status 2]. See “Linking Parameters” below.
4. Set Par 847 [Dig Out1 Bit], Par 852 [Dig Out2 Bit] or Par 857 [Rly Out3 Bit] to 12. Par 324 Bit 12 = EnableHealth status.

Linking Parameters

Use the following procedure to establish a link between Par 846 [Dig Out1 Data], Par 851 [Dig Out2 Data] or Par 856 [Rly Out3 Data] and Par 324 [Fault Status 2].

The user must take care that a hazard cannot occur due to a failure of the digital output or the parameter link function.

1. Using the drive’s Human Interface Module (HIM), select Parameter from the Main Menu and press the Enter key.
2. Using the HIM keypad, enter 846, 850, or 856 and press the Enter key. The parameter value screen will appear.
3. Press ALT and then View (Sel). Next, press the Up or Down Arrow to change “Present Value” to “Defined Link.” Press the Enter key.

4. Press the Enter key to select the “Link” field. Using the HIM keypad, enter 324 as the Source Parameter Number and press the Enter key.

The linked parameter can now be viewed two different ways by repeating the steps above and selecting “Preset Value” or “Define Link.” If an attempt is made to edit the value of a linked parameter, “Parameter is Linked!” will be displayed, indicating that the value is coming from a source parameter and cannot be edited.

5. To remove a link, repeat the steps above and change the source parameter to zero (0).

Verify Operations

Test the safety function for proper operation after initial installation of the DriveGuard Safe Torque Off option. Retest the safety function at the intervals determined by the safety analysis described on [page 15](#).

Verify that both safety channels are functioning according to [Table 4](#).

Table 4 - Channel Operation and Verification

Safety Function Status	Drive In Safe State	Drive In Stopped State	Drive In Stopped State	Drive Able To Run
Safety Channel Operation				
Safe Torque Off Option Terminals 1 & 2	No Power Applied	Power Applied	No Power Applied	Power Applied
PowerFlex 700S/700L Enable Input	No Power Applied	No Power Applied	Power Applied	Power Applied
Description For Verification				
Safe Torque Off Option Monitor Contact Terminals 3 & 4	Closed	Open	Closed	Open
PowerFlex 700S/700L Drive Inhibits Param. 156, Bits 1 & 16	Bit 16 = 0 Bit 1 = 1	Bit 16 = 0 Bit 1 = 1	Bit 16 = 1 Bit 1 = 0	Bit 16 = 0 Bit 1 = 0

Description of Operation

DriveGuard Safe Torque Off Operation

The DriveGuard® Safe Torque Off option disables the drive's output IGBTs by disconnecting the gate control power supply (see [Figure 1](#)). When used in combination with a second safety channel (the Enable input), the system satisfies the requirements of EN ISO 13849-1, PL (d) / Category 3 for safe turn off of torque-producing energy at the output of the drive.

IMPORTANT

The DriveGuard Safe Torque Off option does not eliminate dangerous voltages at the drive output. Input power to the drive must be turned off and safety procedures followed before performing any electrical work on the drive or motor.



ATTENTION: In the event of the failure of two output IGBTs in the drive, when the DriveGuard Safe Torque Off option has controlled the drive outputs to the off state, the drive can provide energy for up to 180° of rotation in a 2-pole motor before torque production in the motor ceases.

Under normal drive operation, the Safe Torque Off relay is energized, the enable input is energized, and gate control power is available to the gate control circuit. If either of these inputs is de-energized, the gate control circuit is disabled and the STS (Status) indicator on the drive will change to a yellow flashing light. When the enable input is de-energized, parameter 156 [Start Inhibits], bit 1 “No Enable” is set to “1.” When the Safe Torque Off relay is de-energized, parameter 156 [Start Inhibits] bit 16 “GateShutDown” is set to “1.” If both inputs are de-energized, only bit 1 “No Enable” will be set to “1” because it takes precedence.

To meet EN ISO 13849-1, PL (d) / Category 3 operation, both safety channel inputs to the drive must be de-energized to safely turn off output to the motor. Refer to the following examples for details.



ATTENTION: By itself, the DriveGuard Safe Torque Off option initiates a coast-to-stop action. Additional protective measures will need to be applied when an application requires a different stopping action.

Figure 1 - Drive Safe Torque Off Circuitry

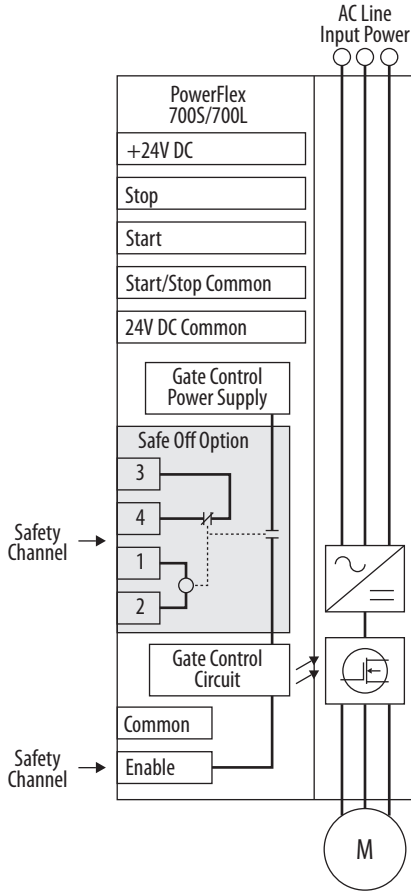

Connection Examples

Example 1 - PowerFlex 700S Drives, Frames 1...6

Safe Torque Off Connection with Coast-to-Stop Action, Dual Channel

Figure 2 - Stop Category 0 - Coast

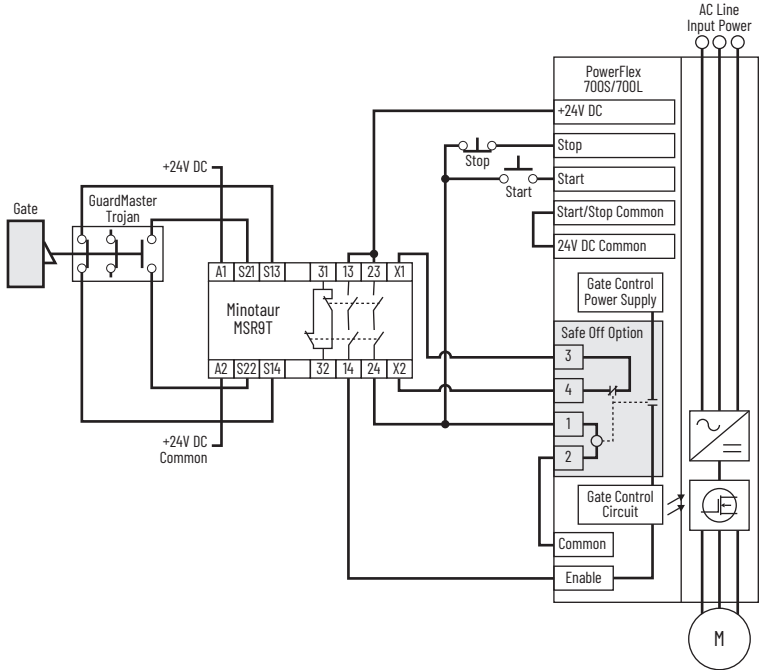

Circuit Status

Circuit shown with guard door closed and system ready for normal drive operation.

Operating Principle

This is a dual channel system with monitoring of the Safe Torque Off circuit and drive. Opening the guard door will switch the input circuits (S13-S14 & S21-S22) to the Minotaur™ monitoring safety relay unit. The output circuits (13-14 & 23-24) will cause the Safe Torque Off option and drive Enable circuit to trip and the motor will coast to stop. To restart the drive, the Minotaur safety relay must first be reset followed by a valid start command to the drive.

Fault Detection

A single fault detected on the Minotaur safety input circuits will result in the lock-out of the system at the next operation and will not cause loss of the safety function.

Example 2 - PowerFlex 700S Drives, Frames 9...14 and PowerFlex 700L Drives, Frames 2, 3A, and 3B
 Safe Torque Off Connection with Coast-to-Stop Action, Dual Channel

Figure 3 - Stop Category 0 - Coast

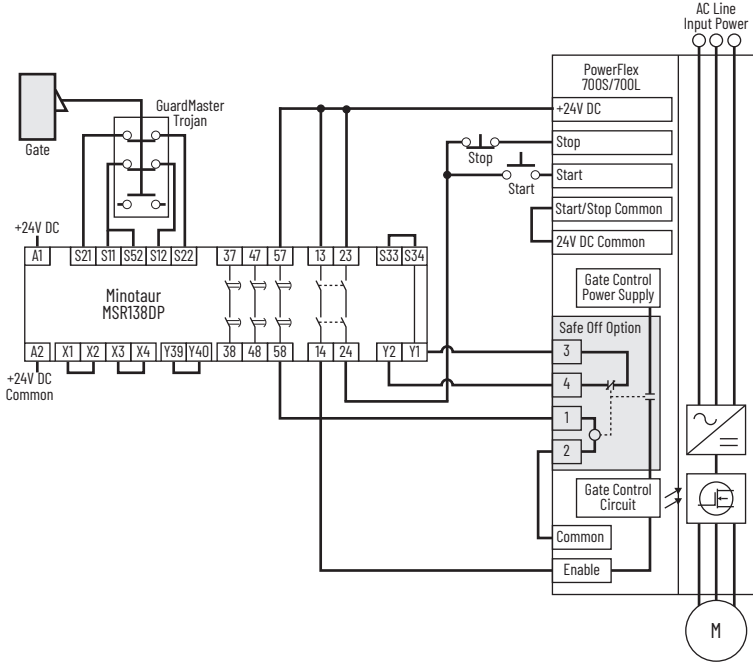

Circuit Status

Circuit shown with guard door closed and system ready for normal drive operation.

Operating Principle

This is a dual channel system with monitoring of the Safe Torque Off circuit and drive. Opening the guard door will switch the input circuits (S11-S12 & S21-S22) to the Minotaur monitoring safety relay unit. The output circuits (13-14 & 23-24) cause the drive Enable circuit to trip and the motor will coast to stop. After the programmed delay, the timed output circuits (57-58) will cause the Safe Torque Off option circuit to trip. To restart the drive, the Minotaur safety relay must first be reset followed by a valid start command to the drive.

Application Considerations

When the hazard analysis for the overall machine determines the need for external mechanical brakes or other stopping means, the external means shall be activated after the removal of power for Stop Category 0.

If the Safe Torque Off option sticks ON, the motor will stop on command due to the enable input. The system cannot be reset when this fault condition exists.

Example 3 - All Drives

Safe Torque Off Connection with Controlled Stop Action, Dual Channel

Figure 4 - Stop Category 1 - Controlled

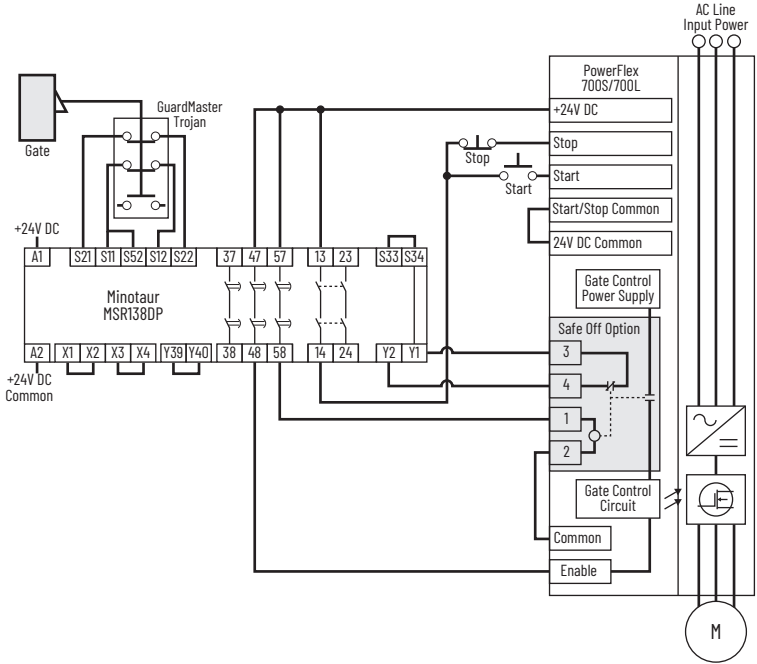

Circuit Status

Circuit shown with guard door closed and system ready for normal operation.

Operating Principle

This is a dual channel system with monitoring of the Safe Torque Off circuit and drive. Opening the guard door will switch the input circuits (S11-S12 & S21-S22) to the Minotaur monitoring safety relay unit. The output circuits (13-14) will issue a Stop command to the drive and cause a controlled deceleration. After the programmed delay, the timed output circuits (47-48 & 57-58) will cause the Safe Torque Off option and the drive Enable circuit to trip. If the motor is rotating when the trip occurs, it will coast to stop. To restart the drive, the Minotaur safety relay must first be reset followed by a valid start command to the drive.

Fault Detection

A single fault detected on the Minotaur safety input circuits will result in the lock-out of the system at the next operation and will not cause loss of the safety function.

If the Safe Torque Off option sticks ON, the motor will stop on command due to the enable input. The system cannot be reset when this fault condition exists.

The function is considered Safe Stop 1 time controlled (SS1-t per IEC 61800-5-2; 4.2.3.3). The controlled deceleration can fail undetected. The safety function will only guarantee a coast to stop after the programmed delay. This function cannot be used if a failure to initiate a controlled deceleration can cause a hazard in the final application.



TIP: PowerFlex® 700L drives using 700S control with Safe Torque Off manufactured before 09/25/2020, are TUV certified.

A
average frequency of a dangerous failure per hour (PFH), 12
average probability of failure on demand (PFDav), 12

C
coast-to-stop action, dual channel
 connection example (frames 1...6), **31**
 connection example (frames 3A...3B), **32**
 connection example (frames 9...13), **32**
controlled stop action, dual channel
 connection example, **33**

D
digital output
 configuration, **27**
DriveGuard Safe Torque Off option
 description, **7**
 operation, **29**

F
functional proof tests, 13

H
hardware enable
 configuration, **26**

I
important safety considerations, 10

L
linking parameters, 27

M
machine safety standards, 8

O
option board
 pre-installation instructions, **15**
 terminal block specifications, **25**
 wiring, **25**

P
performance level, 12
PFDav
 data, **12**
 definition, **12**
PFH
 data, **12**
 definition, **12**

S
safety category 3
 definition, **11**
safety certifications, 9
safety function operation
 verification, **28**
SIL (safety integrity) level, 12
stop category 0 definition, 11
stop category 1 definition, 11

T
Terminal Block
 I/O, **25**

W
wiring
 option board, **25**

Rockwell Automation Support

Use the following resources to access support information.

Technical Support Center	Find help with how-to videos, FAQs, chat, user forums, and product notification updates.	rok.auto/support
Technical Documentation Center	Quickly access and download technical specifications, installation instructions, and user manuals.	rok.auto/techdocs
Knowledgebase	Access Knowledgebase articles.	rok.auto/knowledgebase
Local Technical Support Phone Numbers	Locate the telephone number for your country.	rok.auto/phonesupport
Literature Library	Find installation instructions, manuals, brochures, and technical data publications.	rok.auto/literature
Product Compatibility and Download Center (PCDC)	Download firmware, associated files (such as AOP, EDS, and DTM), and access product release notes.	rok.auto/pcdc

Waste Electrical and Electronic Equipment (WEEE)







At the end of life, this equipment should be collected separately from any unsorted municipal waste.

Rockwell Automation maintains current product environmental information on its website at rok.auto/pec.

Your comments help us serve your documentation needs better. If you have any suggestions on how to improve our content, complete the form at rok.auto/docfeedback.

For technical support, visit rok.auto/support.

Rockwell Otomasyon Ticaret A.Ş. Kar Plaza İş Merkezi E Blok Kat:6 34752, İçerenköy, İstanbul, Tel: +90 (216) 5698400 EEE Yönetmeliğine Uygundur

Connect with us.    

rockwellautomation.com — expanding human possibility™

AMERICAS: Rockwell Automation, 1201 South Second Street, Milwaukee, WI 53204-2496 USA, Tel: (1) 414.382.2000, Fax: (1) 414.382.4444

EUROPE/MIDDLE EAST/AFRICA: Rockwell Automation NV, Pegasus Park, De Kleetlaan 12a, 1831 Diegem, Belgium, Tel: (32) 2 663 0600, Fax: (32) 2 663 0640

ASIA PACIFIC: Rockwell Automation, Level 14, Core F, Cyberport 3, 100 Cyberport Road, Hong Kong, Tel: (852) 2887 4788, Fax: (852) 2508 1846

UNITED KINGDOM: Rockwell Automation Ltd, Pitfield, Kiln Farm Milton Keynes, MK11 3DR, United Kingdom, Tel: (44)(1908) 838-800, Fax: (44)(1908) 261-917

Allen-Bradley, DriveGuard, expanding human possibilities, Minotaur, PowerFlex, and, Rockwell Automation are trademarks of Rockwell Automation, Inc.

Trademarks not belonging to Rockwell Automation are property of their respective companies.



Publication 20D-UM007J-EN-P - October 2022

Supersedes Publication 20D-UM007I-EN-P - December 2020

Copyright © 2022 Rockwell Automation, Inc. All rights reserved. Printed in the U.S.A.