

VPAR Linear Electric Actuator

Superior Motion Control and Axis Coordination

Features and Benefits

- Fully assembled and ready to mount
- Axial or parallel motor mount
- Operates without externally mounted limit or home switches
- Retains position during power loss for faster machine start
- Eliminates piping, valving, air or oil supply
- Linear feed force of up to 2500 N
- Position repeatability of $\pm 0.02\text{mm}$ (0.0008 in)
- Cost effective solution with single cable connection
- Simplified commissioning by use of standard Allen Bradley single cable
- Optional 24VDC holding brakes

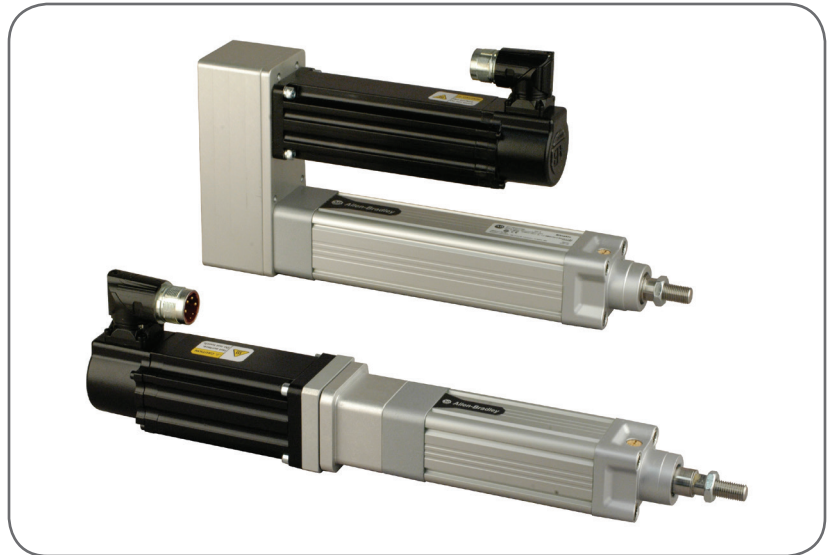

Designed to Save Operating Installation Cost while Providing Top Performance

The new Allen Bradley® series of VPAR linear electric actuator provide flexible servo-control with superior accuracy.

Due to the ability to synchronize and coordinate with multi-axis machine motions, the VPAR actuators provide a dynamic and precise response for a wide range of linear motion applications.

Available in three ISO15552 pneumatic-class frame sizes (32, 40, and 63), the VPAR is an excellent upgrade solution for pneumatic systems.

The single cable design makes installation, commissioning and changeout of these actuators fast and easy, increasing customer uptime and reducing cost.

Electric actuators are commonly used in packaging, material handling, and assembly machine applications across a variety of industries.

Kinetix Drive Compatibility

Full integration with Kinetix 5500 and Kinetix 5700 Servo Drives.
Direct compatibility with single cable installation (no DSL converter kit required).

Product Performance

Frame	Electric Cylinder Catalog Number	Peak Feed Force N (lb)	Continuous Stall Force N (lb)	Speed, Max m/s (in/s)	Stroke Lengths mm (in)
32	VPAR-A1xxxB-Pxx	300 (67)	240 (54)	0.15 (5.9)	100 (3.94) 200 (7.87) 300 (11.81) 400 (15.75)
	VPAR-B1xxxB-Wxx				
	VPAR-A1xxxE-Pxx	350 (79)	280 (63)	0.50 (19.7)	
	VPAR-B1xxxE-Wxx				
40	VPAR-A2xxxC-Pxx	525 (118)	420 (94)	0.25 (9.8)	100 (3.94) 200 (7.87) 300 (11.81) 400 (15.75) 600 (23.62)
	VPAR-B2xxxC-Wxx				
	VPAR-A2xxxF-Pxx	800 (180)	640 (144)	0.64 (25.2)	
	VPAR-B2xxxF-Wxx				
63	VPAR-A3xxxE-Pxx	2500 (562)	2000 (450)	0.50 (19.7)	100 (3.94) 200 (7.87) 300 (11.81) 400 (15.75) 600 (23.62) 800 (31.50)
	VPAR-B3xxxE-Qxx				
	VPAR-A3xxxH-Pxx	1625 (365)	1300 (292)	1.0 (39.4)	
	VPAR-B3xxxH-Qxx				

Mounting and Rod-End Accessories

For accessory catalog numbers, please refer to KNX-TD002 (Kinetix Linear Motor Specification).

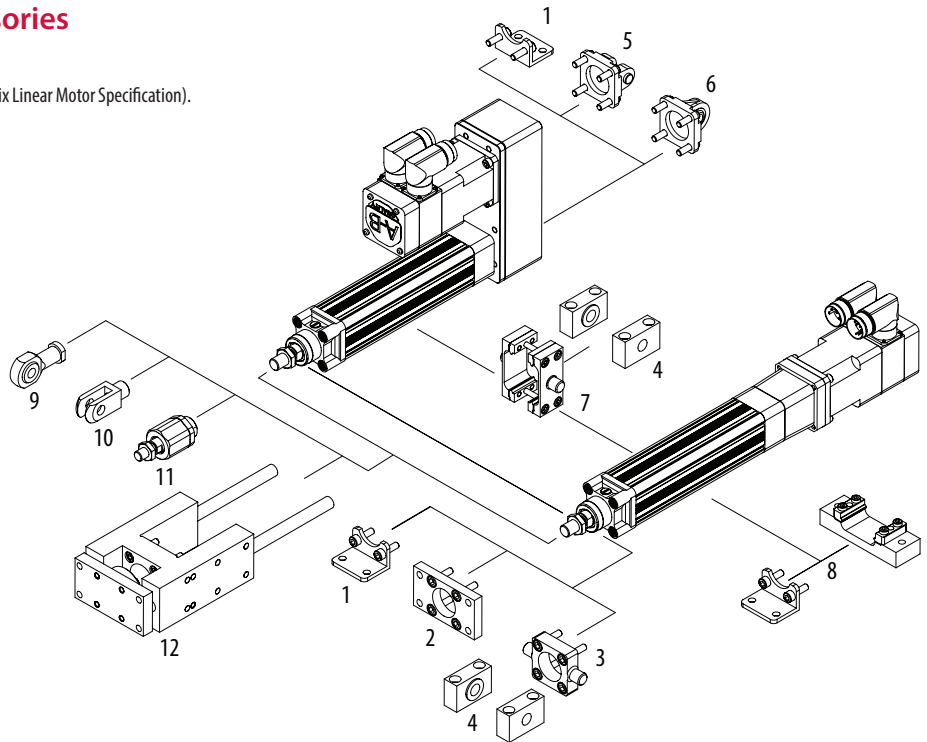

Connect with us. [f](#) [i](#) [in](#) [t](#)

rockwellautomation.com

expanding human possibilit

AMERICAS: Rockwell Automation, 1201 South Second Street, Milwaukee, WI 53204-2496 USA, Tel: (1) 414.382.2000, Fax: (1) 414.382.4444
 EUROPE/MIDDLE EAST/AFRICA: Rockwell Automation NV, Pegasus Park, De Kleetlaan 12a, 1831 Diegem, Belgium, Tel: (32) 2 663 0600, Fax: (32) 2 663 0640
 ASIA PACIFIC: Rockwell Automation, Level 14, Core F, Cyberport 3, 100 Cyberport Road, Hong Kong, Tel: (852) 2887 4788, Fax: (852) 2508 1846