

Mounting Clips for Capacitive Touch Terminals

Catalog Number 2711P-RMCC

Topic	Page
Install the PanelView 5510 Capacitive Touch Terminals	2
Additional Resources	3

This document provides instructions on how to install a PanelView™ 5510 Capacitive Touch terminal in a panel or enclosure using 2711P-RMCC mounting clips.

The number of clips that are used for installation varies by device. The 2711P-RMCC mounting clip kit includes eight clips. If you need more than eight clips, order multiple 2711P-RMCC mounting clip kits.

Table 1 - Number of Clips Used by Terminal Size

Number of Clips Used	Number of Kits Required	PanelView 5510 Capacitive Touch Terminal
8	1	7 in. terminal
14	2	10.1 in. terminal
14	2	12.1 in. terminal
20	3	15.6 in. terminal
20	3	18.5 in. terminal
22	3	21.5 in. terminal

Gasket and Clip Hole Location

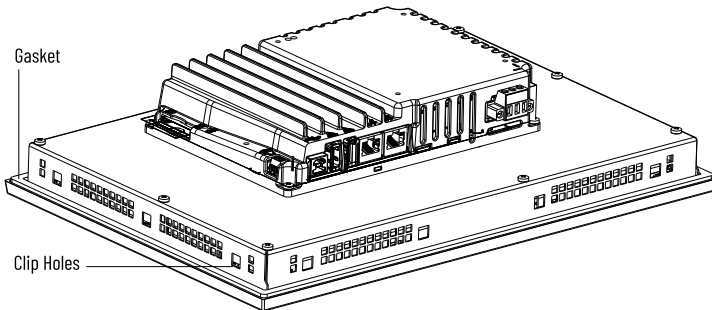

Install the PanelView 5510 Capacitive Touch Terminals

To mount the capacitive touch terminal in a panel, follow these steps.

IMPORTANT We recommend two people work together to install the terminal; one person to hold the terminal in place while a second person installs the mounting clips.

IMPORTANT The gasket is part of the terminal and forms a compression-type seal. Do not use sealing compounds.

1. From in front of the panel, insert the bottom edge of the terminal into the cutout.
2. Tilt the rest of the terminal forward until the sealing gasket is completely flush against the panel surface. Hold the terminal in place so it does not fall out of the panel.

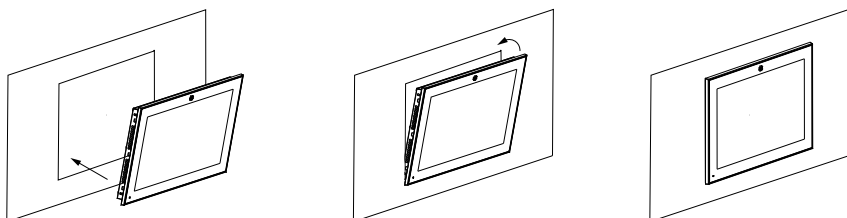

3. From behind the panel, on all four sides of the terminal, insert a mounting clip into each clip hole (A).
4. Rotate each clip down (B) and pull it outward (C).
5. Use a torque limiting screwdriver, which is fitted with a 1.5 mm hex key bit to tighten the mounting clip screws (D).
6. Torque the mounting clip screws to 0.2 N•m (1.8 lb•in) using the specified sequence in [Figure 1 on page 3](#).
7. Repeat [step 6](#) until all mounting clips are at the specified torque.

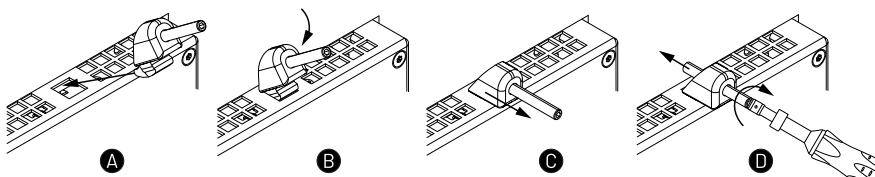

ATTENTION: Tighten the mounting clips to the specified torque to provide a proper seal and to help prevent damage to the product. Rockwell Automation assumes no responsibility for water or chemical damage to the product or other equipment within the enclosure because of improper installation.

Figure 1 - Mounting Clips Tighten and Torque Sequence by Terminal Size

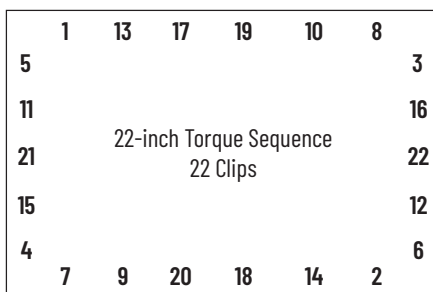
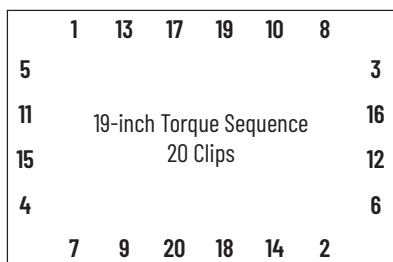
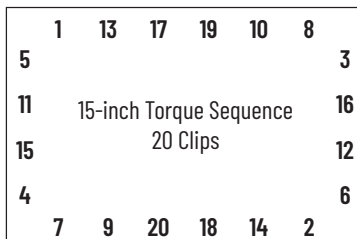
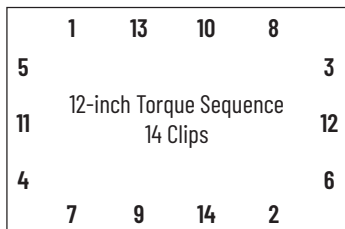
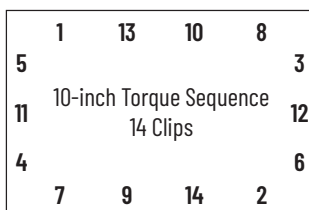
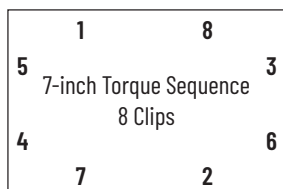

Additional Resources

These documents contain additional information concerning related products from Rockwell Automation.

Resource	Description
PanelView 5510 Terminals User Manual, publication 2715P-UM001	Provides instructions on how to install, configure, and operate the PanelView 5510 terminals
Industrial Automation Wiring and Grounding Guidelines, publication 1770-4.1	Provides general guidelines for installing a Rockwell Automation industrial system
Product Certifications website, rok.auto/certifications	Provides declarations of conformity, certificates, and other certification details

You can view or download publications at rok.auto/literature.

Rockwell Automation Support

Use these resources to access support information.

Technical Support Center	Find help with how-to videos, FAQs, chat, user forums, Knowledgebase, and product notification updates.	rok.auto/support
Local Technical Support Phone Numbers	Locate the telephone number for your country.	rok.auto/phonesupport
Technical Documentation Center	Quickly access and download technical specifications, installation instructions, and user manuals.	rok.auto/techdocs
Literature Library	Find installation instructions, manuals, brochures, and technical data publications.	rok.auto/literature
Product Compatibility and Download Center (PCDC)	Download firmware, associated files (such as AOP, EDS, and DTM), and access product release notes.	rok.auto/pcdc

Documentation Feedback

Your comments help us serve your documentation needs better. If you have any suggestions on how to improve our content, complete the form at rok.auto/docfeedback.





Waste Electrical and Electronic Equipment (WEEE)



At the end of life, this equipment should be collected separately from any unsorted municipal waste.

Rockwell Automation maintains current product environmental compliance information on its website at rok.auto/pec.

Rockwell Otomasyon Ticaret A.Ş. Kar Plaza İş Merkezi E Blok Kat:6 34752, İçerenköy, İstanbul, Tel: +90 (216) 5698400 EEE Yönetmeliğine Uygundur

Connect with us.    

rockwellautomation.com

expanding human possibility™

AMERICAS: Rockwell Automation, 1201 South Second Street, Milwaukee, WI 53204-2498 USA, Tel: (1) 414.382.2000

EUROPE/MIDDLE EAST/AFRICA: Rockwell Automation NV, Pegasus Park, De Kleeflaan 12a, 1831 Diegem, Belgium, Tel: (32) 2663 0600

ASIA PACIFIC: Rockwell Automation SEA Pte Ltd, Z Corporation Road, #04-05, Main Lobby, Corporation Place, Singapore 618494, Tel: (65) 6510 6608

UNITED KINGDOM: Rockwell Automation Ltd., Pitfield, Kiln Farm, Milton Keynes, MK11 3DR, United Kingdom, Tel: (44)(1908) 638-800

Allen-Bradley, expanding human possibility, PanelView, and Rockwell Automation are trademarks of Rockwell Automation, Inc. Trademarks not belonging to Rockwell Automation are property of their respective companies.



PN-694736

Publication VIEW-IN003A-EN-P - October 2024

Copyright © 2024 Rockwell Automation, Inc. All rights reserved. Printed in the U.S.A.