

## VersaView 6300 DC Connector Assemblies and Replacement Mounting Clips

Catalog Numbers 6300V-DCCONN, 6300V-DCCONN2, 6300V-DCCONN3, 6300V-MTGCLIP16

Topic	Page
Required Tools for Installation	1
Install a DC Connector Assembly	1
Install the Replacement Mounting Clips	3

The instructions in this publication apply to the following items:

- A connector assembly for DC-powered VersaView® 6300 PCs and VersaView 6300 monitors
- Replacement mounting clips for VersaView 6300P panel PCs and VersaView 6300M monitors

### Required Tools for Installation

The following tools are to install a 6300V-DCCONN, 6300V-DCCONN2, or 6300V-DCCONN3 DC connector assembly:

- Adjustable torque screwdriver with metric flat-blade screw bits
- Wire stripper, cutter, and crimper tool
- Cutting pliers
- Safety glasses

The following tools are to install the replacement 6300V-MTGCLIP16 mounting clips:

- 1.5 mm hex key (two are supplied with the mounting clips)
- Adjustable torque driver with 1.5 mm hex key bit
- Safety glasses

### Install a DC Connector Assembly

The connector assembly provides strain relief for the DC power wires by reducing their movement. To assemble and attach the connector assembly, perform the following steps.

---

**IMPORTANT** DC power wires must be of stranded copper and sized according to [Figure 1 on page 2](#).

---

1. Disconnect power to the computer.
2. Remove the DC terminal block from the computer chassis.
3. Open the power connector assembly kit that ships with the computer (A in [Figure 2 on page 3](#)).
4. Insert the cable tie through the slots of the appropriate connector half (B in [Figure 2 on page 3](#)).
5. Strip the end of each DC power wire to the length in [Figure 1 on page 2](#).
6. Insert each stripped end into the DC terminal block as shown in [Figure 1](#).

7. Tighten the screws on top of the terminal block to secure the DC power wires to the torque value in [Figure 1](#).
8. Slide the connector half with the attached tie onto the end of the DC terminal block (C in [Figure 2 on page 3](#)).
9. Tighten the cable tie so it is snug against the terminal wires.
10. Use cutting pliers to cut the excess part of the cable tie (D in [Figure 2 on page 3](#)).
11. Install the white label supplied with the kit (E in [Figure 2 on page 3](#)).



The white label can be used for identification or other information.

12. Align and install the other connector clamp half to complete the assembly (F in [Figure 2 on page 3](#)).



When installed correctly, both tabs of the clamp half lock into place.

13. Reconnect the DC terminal block with the connector assembly to the computer chassis.  
Torque the DC terminal block flange screws to the values in [Figure 1](#).
14. Turn on the main power switch or breaker.

Figure 1 - DC Terminal Block Connection Specifications

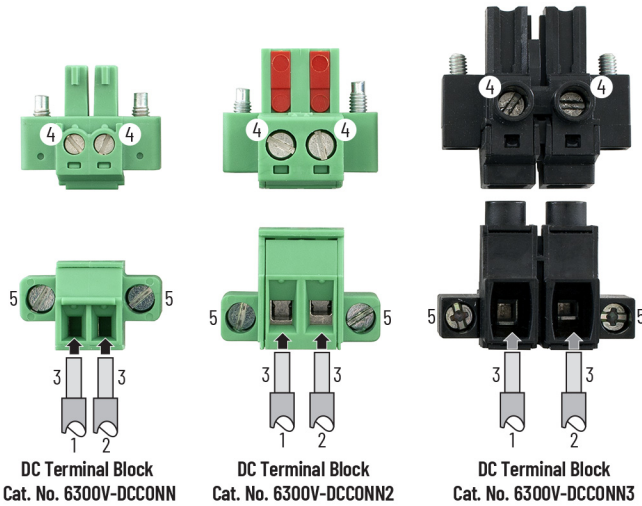

Item	Description	Attribute		
		6300V-DCCONN	6200V-DCCONN2	6300V-DCCONN3
1	DC+ (24V DC nominal) recommended power wire size	1.5 mm <sup>2</sup> (16 AWG)	2.5 mm <sup>2</sup> (14 AWG)	4 mm <sup>2</sup> (12 AWG)
2	DC- (0V DC) recommended power wire size			
3	Stripped wire length	7 mm (0.275 in.)		
4	Torque range to secure DC power wires	0.22...0.25 N•m (0.16...0.18 ft•lb)	0.5...0.6 N•m (0.37...0.44 ft•lb)	0.4...0.5 N•m (0.3...0.37 ft•lb)
5	Torque value to reinstall DC terminal block to computer	0.5...0.6 N•m (0.37...0.44 ft•lb)		

Figure 2 - DC Connector Assembly Sequence

**IMPORTANT**

The DC connector assembly that is shown in [Figure 2](#) is only for illustrative purposes. Your DC connector assembly can differ in size, shape, and color to what is shown in [Figure 2](#).

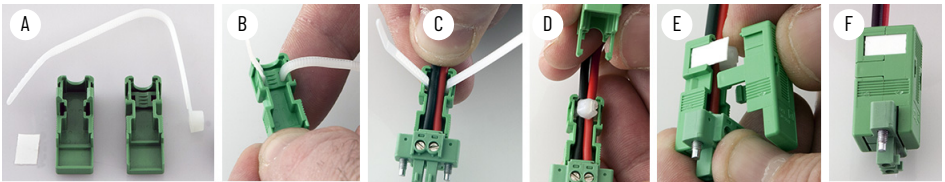

## Install the Replacement Mounting Clips

To replace mounting clips on VersaView 6300P panel PCs and 6300M monitors, perform the following steps.

1. Disconnect power to the computer or monitor.
2. Slide the replacement mounting clips into the holes on the sides of the computer or monitor as shown at right. For the various hole locations, see [Figure 3 on page 4](#).
3. Hand-tighten the mounting clips according to the tighten sequence in [Figure 3 on page 4](#).
4. With the supplied 1.5 mm hex key, tighten the mounting clips to the tighten sequence in [Figure 3 on page 4](#).
5. With the adjustable torque driver and 1.5 mm hex key bit, tighten the mounting clips to a torque of 0.2 N•m (1.8 lb•in) by the tighten sequence in [Figure 3 on page 4](#).
6. Repeat this process at least three times until the clips are torqued properly to 0.2 N•m (1.8 lb•in).  
Verify that the gasket is compressed uniformly against the panel.



**ATTENTION:** Tighten the mounting clips to the specified torque to provide a proper seal and to help prevent product damage. Rockwell Automation assumes no responsibility for water or chemical damage to the computer or other equipment within the enclosure because of improper installation.

**Figure 3 - Tighten and Torque Sequence for the Mounting Clips**

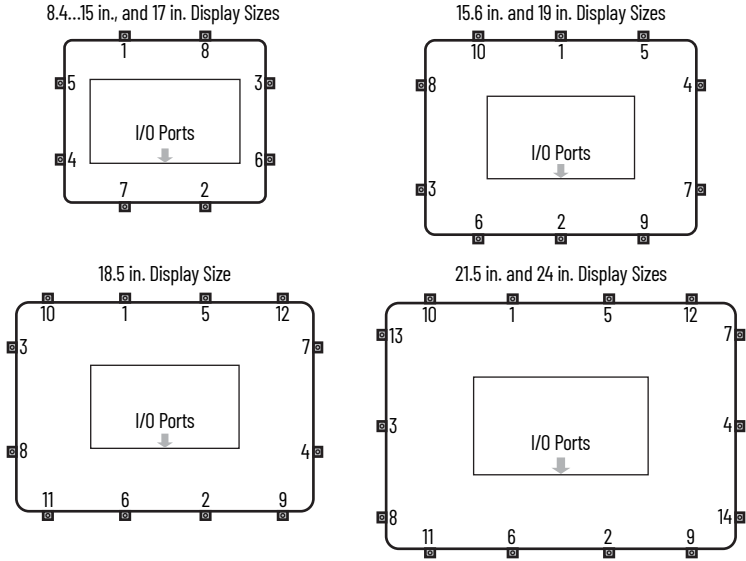

## Waste Electrical and Electronic Equipment (WEEE)







At the end of life, this equipment should be collected separately from any unsorted municipal waste.

Rockwell Automation maintains current product environmental compliance information on its website at [rok.auto/pec](http://rok.auto/pec).

Your comments help us serve your documentation needs better. If you have any suggestions on how to improve our content, complete the form at [rok.auto/docfeedback](http://rok.auto/docfeedback).

For technical support, visit [rok.auto/support](http://rok.auto/support).

Rockwell Otomasyon Ticaret A.Ş. Kar Plaza İş Merkezi E Blok Kat:6 34752, İçerenköy, İstanbul, Tel: +90 (216) 5698400  
EEE Yönetmeliğine Uygundur

Connect with us.    

[rockwellautomation.com](http://rockwellautomation.com) — expanding human possibility™

AMERICAS: Rockwell Automation, 1201 South Second Street, Milwaukee, WI 53204-2496 USA, Tel: (1) 414.382.2000, Fax: (1) 414.382.4444  
EUROPE/MIDDLE EAST/AFRICA: Rockwell Automation NV, Pegasus Park, De Kleetlaan 12a, 1831 Diegem, Belgium, Tel: (32) 2 663 0600, Fax: (32) 2 663 0640  
ASIA PACIFIC: Rockwell Automation, Level 14, Core F, Cyberport 3, 100 Cyberport Road, Hong Kong, Tel: (852) 2887 4788, Fax: (852) 2508 1846

Allen-Bradley, expanding human possibility, Rockwell Automation, and VersaView are trademarks of Rockwell Automation, Inc.  
Trademarks not belonging to Rockwell Automation are property of their respective companies.



Publication 6300V-IN003A-EN-P - January 2021

Copyright © 2021 Rockwell Automation, Inc. All rights reserved. Printed in Italy.

PN-618253  
Vendor Code 80460052.00  
DIR 10005949197 (Version 00)