

Installation Instructions

Original Instructions



Allen-Bradley
by ROCKWELL AUTOMATION

Feedback Battery Box

Catalog Number 2198-KTBT

Topic	Page
Summary of Changes	1
Install Battery	1
Install or Replace Battery Box	2
Additional Resources	4

Summary of Changes

This publication contains the following new or updated information. This list includes substantive updates only and is not intended to reflect all changes.

Topic	Page
Updated illustrations to reflect the new battery box design.	Throughout

Use these installation instructions to install or replace a battery box, install a battery, and prepare a feedback cable for a battery box installation. The battery box requires a 3.6V, ER14252, or equivalent, 1/2AA size battery that you supply.

Install Battery

The battery box requires a 3.6V, ER14252, or equivalent, 1/2AA size battery. To install the battery, do the following.

1. To open the battery box, release the four snap-fit tabs.
2. Insert the battery as shown.
3. Replace the cover and check that all four snap-fit tabs are engaged.

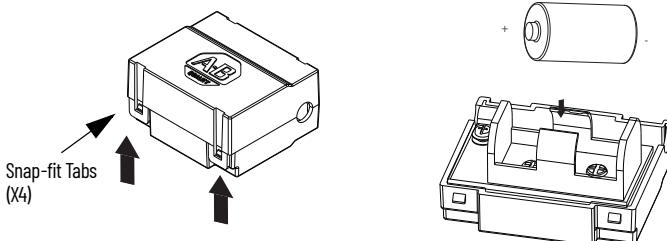

IMPORTANT To avoid the loss of position data, be sure to replace the battery within 10 minutes.

Install or Replace Battery Box

To install the battery box, follow the steps in [Prepare Battery Box](#) and continue with [Install Battery Box](#). To replace the battery box, follow all the steps in this section.

Prepare Battery Box

To prepare your new battery box for installation or replacement, do the following.

1. Release the four snap-fit tabs and remove the battery box cover.
2. Remove and save the cable clamp screw and the cable clamp.

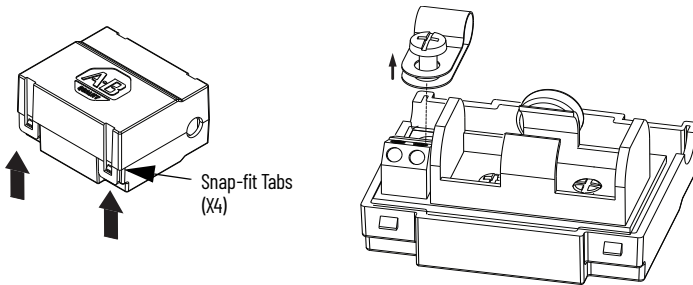

Remove the Battery Box from the Feedback Cable

1. Release the four snap-fit tabs and remove the battery box cover.
2. Loosen the + and - terminal screws and pull out the black and red wires.

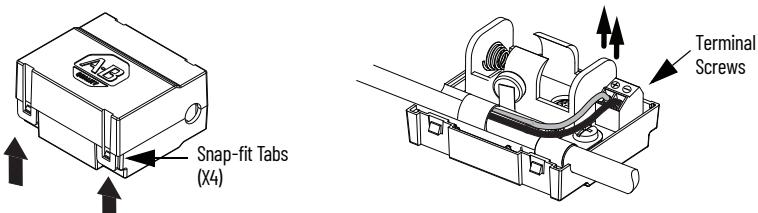

- Remove the cable-clamp screw, cable, and the cable clamp.

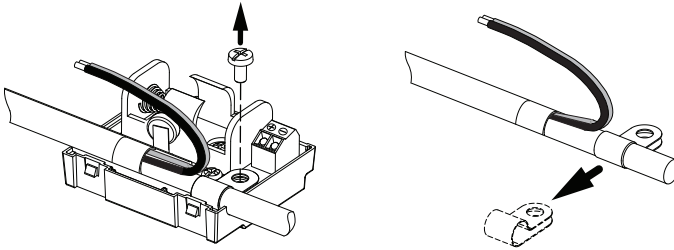

Install Battery Box

- Position the cable clamp on the feedback cable such that the encoder battery-power wires exit the shrink tube near the center of the battery box.
- Place the cable in the battery box as shown and secure to the box with the supplied cable-clamp screw. Torque the cable-clamp screw to 0.2 N•m (1.77 lb•in).

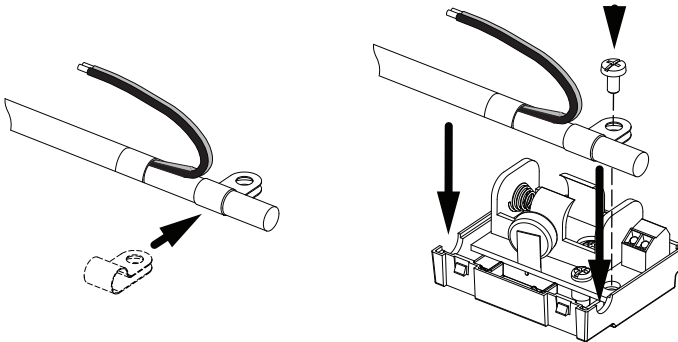

- Insert the wires into + and - terminals. Torque the cable-clamp screw to a maximum of 0.35 N•m (3.098 lb•in).

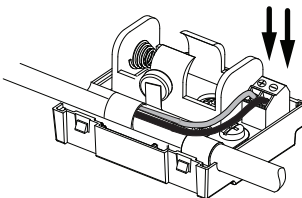

Terminal	Wire Color
+	Red
-	Black

- Install the battery. See [Install Battery on page 1](#).
- Replace the cover.

Additional Resources

These documents contain additional information concerning related products from Rockwell Automation. You can view or download publications at rok.auto/literature.

Resource	Description
Kinetix® 5700, 5500, 5300, and 5100 Servo Drives Specifications Technical Data, publication KNX-TD003	Provides product specifications for Kinetix Integrated Motion over the EtherNet/IP™ network and EtherNet/IP networking servo drive families.
Kinetix Rotary and Linear Motion Cable Specifications Technical Data, publication KNX-TD004	Product specifications for Kinetix 2090 motor and interface cables.
Kinetix 5100 Single-axis EtherNet/IP Servo Drives User Manual, publication 2198-UM004	Information on how to install, configure, start, and troubleshoot your Kinetix 5100 servo drive system.
Industrial Automation Wiring and Grounding Guidelines, publication 1770-4.1	Provides general guidelines for installing a Rockwell Automation industrial system.
Product Certifications website, rok.auto/certifications .	Provides declarations of conformity, certificates, and other certification details.

Waste Electrical and Electronic Equipment (WEEE)



At the end of life, this equipment should be collected separately from any unsorted municipal waste.

Rockwell Automation maintains current product environmental compliance information on its website at rok.auto/pec.

Your comments help us serve your documentation needs better. If you have any suggestions on how to improve our content, complete the form at rok.auto/docfeedback.

For technical support, visit rok.auto/support.

Rockwell Otomasyon Ticaret A.Ş. Kar Plaza İş Merkezi E Blok Kat:6 34752, İçerenköy, İstanbul, Tel: +90 (216) 5698400 EEE Yönetmeliğine Uygundur

Connect with us.    

rockwellautomation.com

expanding human possibility®

AMERICAS: Rockwell Automation, 1201 South Second Street, Milwaukee, WI 53204-2496 USA, Tel: (1) 414.382.2000, Fax: (1) 414.382.4444

EUROPE/MIDDLE EAST/AFRICA: Rockwell Automation NV, Pegasus Park, De Kleetlaan 12a, 1831 Diegem, Belgium, Tel: (32) 2 663 0600, Fax: (32) 2 663 0640

ASIA PACIFIC: Rockwell Automation, Level 14, Core F, Cyberport 3, 100 Cyberport Road, Hong Kong, Tel: (852) 2887 4788, Fax: (852) 2508 1846

UNITED KINGDOM: Rockwell Automation Ltd, Pitfield, Kiln Farm Milton Keynes, MK11 3DR, United Kingdom, Tel: (44)(1908) 838-800, Fax: (44)(1908) 261-917

Allen-Bradley, expanding human possibility, Kinetix, and Rockwell Automation are trademarks of Rockwell Automation, Inc.

EtherNet/IP is a trademark of ODVA, Inc.

Trademarks not belonging to Rockwell Automation are property of their respective companies.



PN-690257

Publication 2198-IN022B-EN-P - June 2023 | Supersedes Publication 2198-IN022A-EN-P - May 2019

PN-690257

Copyright © 2023 Rockwell Automation, Inc. All rights reserved. Printed in the U.S.A.