

## Running Out of Panel Space?

Bulletin 1492

Use multi-circuit terminal blocks to optimize your panel

### Customer Need

As the number of devices used on the plant floor increases, so does the number connections required to allow these devices to communicate. This creates a 1:1 correlation between the number of connections and the number of terminal blocks that are required to serve this need. Such a correlation can fill up any available panel space quickly, which can limit system architecture expansion capabilities or require that more time and money are spent on panel upgrades and reconfigurations.

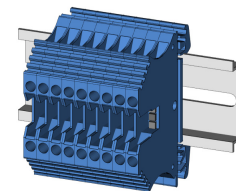
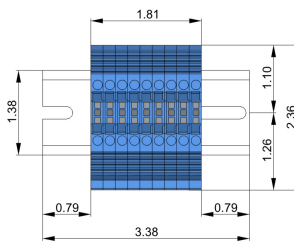
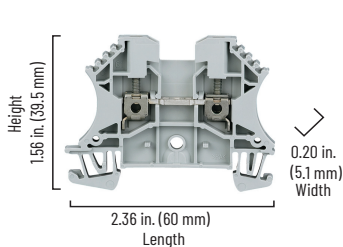

1492-J...

### Component Solution

Allen-Bradley® Bulletin 1492 Multi-Circuit Terminal Blocks create a space savings of up to 33% compared to traditional single-level terminal blocks. Their increased height accommodates more connections along the same DIN rail width, reducing the number of terminal blocks required and freeing up space on the DIN rail.

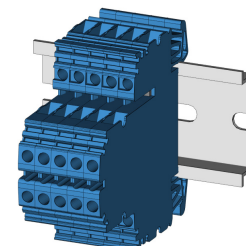
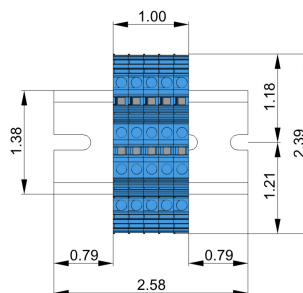
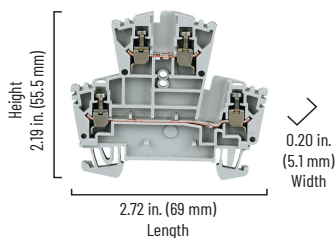

1492-JD...

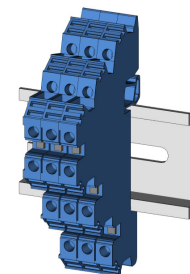
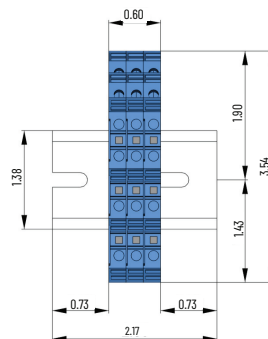
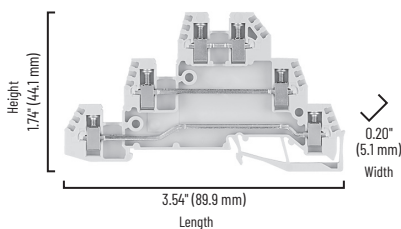

1492-WTF...

## Product Selection

Description	Pkg. Qty.	Cat. No.
<b>Standard Feed-Through (IEC Screw-Type)</b>		
1492-J IEC Terminal Block, One-Circuit Feed-Through Block, 2.5 mm <sup>2</sup> (# 24... # 12 AWG), Standard Feed-Through, Grey (Standard)	100	1492-J3
1492-J IEC Terminal Block, Two-Circuit Feed-Through Block, 2.5 mm <sup>2</sup> (# 24... # 12 AWG), Standard Feed-Through, Grey (Standard)	100	1492-JD3
1492-W IEC Terminal Block, Three-Circuit Feed-Through Block, 2.5 mm <sup>2</sup> (# 24 ... # 12 AWG), Standard Feed-Through, Grey (Standard)	50	1492-WTF3
<b>Standard Feed-Through (IEC Spring Clamp)</b>		
Spring Clamp Terminal Block, One-Circuit Feed-Through Block, 2.5 mm <sup>2</sup> (# 30...# 12 AWG), Standard Feed-Through, Grey (Standard)	100	1492-L3
Spring Clamp Terminal Block, Two-Circuit Feed-Through Block, 2.5 mm <sup>2</sup> (# 22 AWG - # 14 AWG), Standard Feed-Through, Grey (Standard)	25	1492-LD3
Spring Clamp Terminal Block, Three-Circuit Feed-Through Block with multiple cross connection points, 2.5 mm <sup>2</sup> (# 22 AWG - # 14 AWG), Standard Feed-Through, Grey (Standard)	25	1492-LTF3
<b>Fuse Block (IEC Screw-Type)</b>		
1492-W IEC Terminal Block, One-Circuit Fuse Block (5 x 20 mm Fuses, Type W), 4 mm <sup>2</sup> (# 22...# 10 AWG) or 2.5 mm <sup>2</sup> (# 22...# 12 AWG), Non-Indicating, Black (Standard)	50	1492-WFB4
1492-J IEC Terminal Block, Two-Level Block, 2.5 mm <sup>2</sup> (# 22...# 12 AWG), Hinged-arm fuse circuit, Grey (Standard), 500V/600V AC/DC	50	1492-JD3FB
1492-J IEC Terminal Block, Three-Level Feed-Through Block, 4 mm <sup>2</sup> (# 22...# 12 AWG) or 2.5 mm <sup>2</sup> (# 26...# 12 AWG), Hinged-arm fuse circuit, Grey (Standard), 500V/600V AC/DC	50	1492-JDG3FB
<b>Standard Feed-Through (IEC Push-in)</b>		
1492-P Push-in Terminal Block, One-Circuit Feed-Through Block, 2.5 mm <sup>2</sup> (# 28...# 12 AWG), Standard Feed-Through, Grey (Standard)	100	1492-P3
1492-P Push-in Terminal Block, Two-Circuit Feed-Through Block, 2.5 mm <sup>2</sup> (# 28 AWG - # 12 AWG), Standard Feed-Through, Grey (Standard)	50	1492-PD3
1492-P Push-in Terminal Block, Three-Circuit Feed-Through Block, 2.5 mm <sup>2</sup> (# 28 AWG - # 12 AWG), Standard Feed-Through, Grey (Standard)	50	1492-PT3
<b>Fuse Block (IEC Push-in)</b>		
1492-P Push-in Terminal Block, One-Circuit Fuse Block (5 x 20 mm Fuses), 4 mm <sup>2</sup> (# 26...# 10 AWG), Non-Indicating, Black (Standard)	50	1492-PFB4
1492-P Push-in Terminal Block, Two-Circuit Fuse Block (5 x 20 mm Fuses), 4 mm <sup>2</sup> (# 26...# 10 AWG), Non-Indicating, Black (Standard)	50	1492-PDFB4
1492-P Push-in Terminal Block, Two-Circuit Fuse Block with Ground (5 x 20 mm Fuses), 4 mm <sup>2</sup> (# 26...# 10 AWG), Non-Indicating, Black (Standard)	50	1492-PDGF4

For more information on 1492 Multi-Circuit Terminal Blocks, see: [1492 Screw Multi-Circuit Feed-Through](#) (1492-J), [1492 Spring Multi-Circuit Feed-Through](#) (1492-L), and [1492-P Multi-circuit Feed-through](#) (1492-P)

## Additional Resources

These documents contain additional information about related products from Rockwell Automation.

Resource	Description
1492-J and 1492-L Terminal Blocks Specifications Technical Data, publication <a href="#">1492-TD015</a>	Provides specification data for Bulletin 1492 IEC Screw and 1492 IEC Spring Clamp terminal blocks.
1492-P Terminal Blocks Specifications Technical Data, publication <a href="#">1492-TD017</a>	Provides specification data for Bulletin 1492 IEC Push-in terminal blocks.
Product Selection and Configuration tools, <a href="http://rok.auto/systemtools">rok.auto/systemtools</a>	Helps configure complete, valid catalog numbers and build complete quotes based on detailed product information.
Rockwell Automation Global SCCR tool, <a href="http://rok.auto/sccr">rok.auto/sccr</a>	Provides coordinated high-fault branch circuit solutions for motor starters, soft starters, and component drives.
Product Certifications website, <a href="http://rok.auto/certifications">rok.auto/certifications</a>	Provides declarations of conformity, certificates, and other certification details.

You can view or download publications at [rok.auto/literature](http://rok.auto/literature).

**Notes:**

# Rockwell Automation Support

Use these resources to access support information.

<b>Technical Support Center</b>	Find help with how-to videos, FAQs, chat, user forums, Knowledgebase, and product notification updates.	<a href="http://rok.auto/support">rok.auto/support</a>
<b>Local Technical Support Phone Numbers</b>	Locate the telephone number for your country.	<a href="http://rok.auto/phonesupport">rok.auto/phonesupport</a>
<b>Technical Documentation Center</b>	Quickly access and download technical specifications, installation instructions, and user manuals.	<a href="http://rok.auto/techdocs">rok.auto/techdocs</a>
<b>Literature Library</b>	Find installation instructions, manuals, brochures, and technical data publications.	<a href="http://rok.auto/literature">rok.auto/literature</a>
<b>Product Compatibility and Download Center (PCDC)</b>	Download firmware, associated files (such as AOP, EDS, and DTM), and access product release notes.	<a href="http://rok.auto/pcdc">rok.auto/pcdc</a>





## Documentation Feedback

Your comments help us serve your documentation needs better. If you have any suggestions on how to improve our content, complete the form at [rok.auto/docfeedback](http://rok.auto/docfeedback).

Allen-Bradley, expanding human possibility, and Rockwell Automation are trademarks of Rockwell Automation, Blnc. Trademarks not belonging to Rockwell Automation are property of their respective companies.

Rockwell Automation maintains current product environmental compliance information on its website at [rok.auto/pec](http://rok.auto/pec).

Rockwell Otomasyon Ticaret A.Ş. Kar Plaza İş Merkezi E Blok Kat:6 34752, İçerenköy, İstanbul, Tel: +90 (216) 5698400 EEE Yönetmeliğine Uygundur

Connect with us.    

**rockwellautomation.com** ————— **expanding human possibility®**

AMERICAS: Rockwell Automation, 1201 South Second Street, Milwaukee, WI 53204-2496 USA, Tel: (1) 414.382.2000

EUROPE/MIDDLE EAST/AFRICA: Rockwell Automation NV, Pegasus Park, De Kleetlaan 12a, 1831 Diegem, Belgium, Tel: (32) 2663 0600

ASIA PACIFIC: Rockwell Automation SEA Pte Ltd, 2 Corporation Road, #04-05, Main Lobby, Corporation Place, Singapore 618494, Tel: (65) 6510 6608

UNITED KINGDOM: Rockwell Automation Ltd., Pitfield, Kiln Farm, Milton Keynes, MK11 3DR, United Kingdom, Tel: (44)(1908) 838-800