



# Installation Instructions Instructions pour l'Installation Installationsbeschreibung Procedura di Installazione Instrucciones de Instalación

## AUXILIARY SWITCH CONTACT AUXILIARE HILFSKONTAKT CONTATTO AUSILIARIO CONTACTO AUXILIAR

(Bulletin 1492-ASP3, -ASPH3, -ASPHS3)



**ATTENTION:** To prevent electrical shock, disconnect from power source before installing or servicing.  
**ATTENTION:** Avant le montage et la mise en service, couper l'alimentation secteur pour éviter toutes décharges.  
**ACHTUNG:** Vor Installations- oder Servicearbeiten Stromversorgung unterbrechen, um Elektroschocks zu vermeiden.  
**ATTENZIONE:** Per prevenire infortuni, togliere tensione prima dell'installazione o manutenzione.  
**ATENCION:** Desconéctese de la corriente eléctrica, antes de la instalación o del servicio, a fin de impedir sacudidas eléctricas.

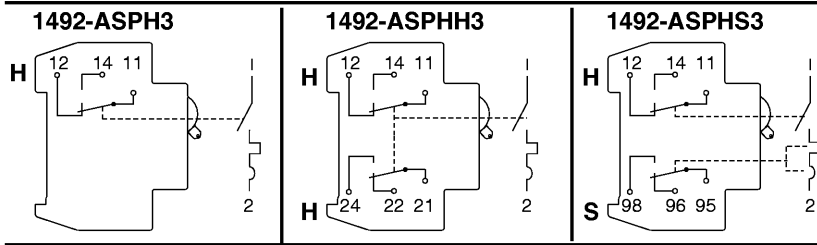

**H**  
Switches when protective device is operated manually or is tripped electrically.  
Commute lorsque le dispositif de protection est actionné manuellement ou déclenché électriquement.  
Wird betätigt, wenn die Schutzvorrichtung von Hand oder elektronisch ausgelöst wird.  
Si inserisce quando il dispositivo di protezione viene azionato manualmente oppure si attiva elettricamente.  
Se conecta cuando el dispositivo de protección se activa manualmente o se enciende de forma electrónica.

**S**  
Switches only when protective device is tripped electrically.  
Commute lorsque le dispositif de protection est déclenché électriquement.  
Wird nur dann betätigt, wenn die Schutzvorrichtung elektronisch ausgelöst wird.  
Si inserisce soltanto quando il dispositivo di protezione si attiva elettricamente.  
Sólo se conecta cuando el dispositivo de protección se enciende de forma eléctrica.

### 1492-SP ... + 1492-ASP3

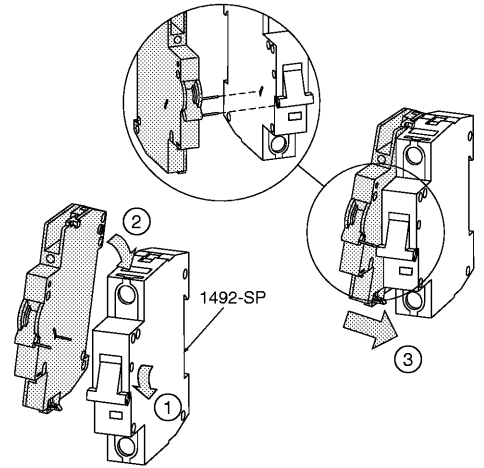

### 1492-SP ... + 1492-ASPHS3/HH3

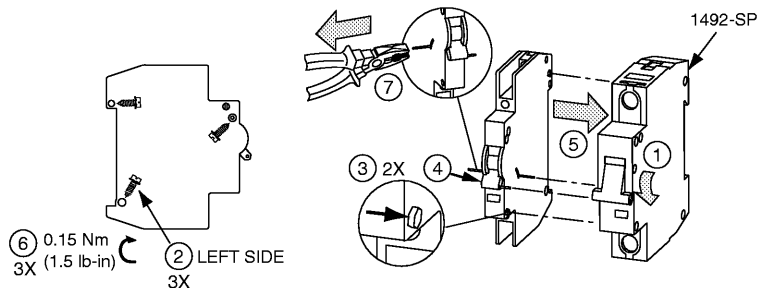

### 1492-RCD ... + 1492-ASPHS3/HH3

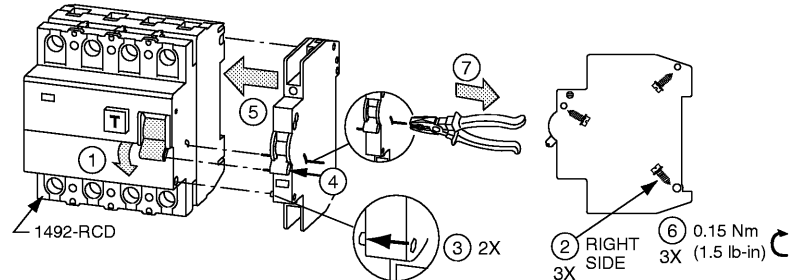

### 1492-ASP3, HH3, HS3

Cu	mm <sup>2</sup>	AWG	8mm (.31 in)	Z0	0.6 x 3.5mm (.024 x .14in)	0.8 Nm (7 lb-in)
	1 x 0.5 - 2.5	1 x #18 - 14				
	2 x 0.5 - 2 x 2.5	2 x #18 - 2 x #14				

### Allowable Combinations and Positions Combinaisons et Positions Possible Zulaessige Kombinationen und Positionen Combinazioni e Posizioni Accettabili Combinaciones y Posiciones Válidas

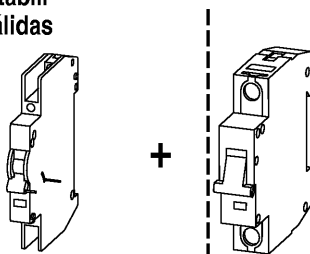

1492-ASP3	1492-ASPH3	1492-ASPHS3	1492-ASPA...	1492-ASPU...	1492-SP...
X					X
	X				X
		X			X
			X		X
				X	X
X			X		X
	X		X		X
		X	X		X

**!**  
Maximum  
Massimo  
Máximo

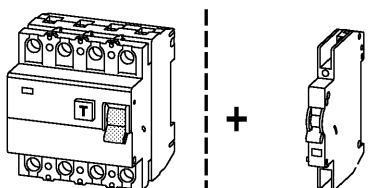

1492-RCD	1492-ASPHS3	1492-ASPH3
X	X	
X		X

**!** Maximum  
Massimo  
Máximo

IEC/EN 62019	le	Ue
AC13	3A	250V
AC15	2A	250V
DC12	0.5A	110V

le	Ue
2A	230VAC
0.5A	110DC

U minimum = 5VDC

① Initial State  
 Etat initial  
 Ausgangszustand  
 Stato iniziale  
 Estado inicial

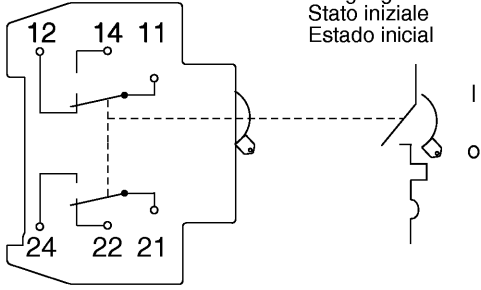

① Initial State  
 Etat initial  
 Ausgangszustand  
 Stato iniziale  
 Estado inicial

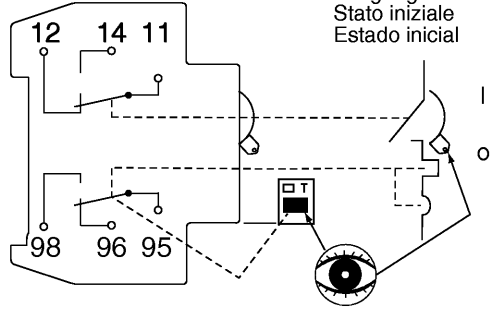

② ON/I

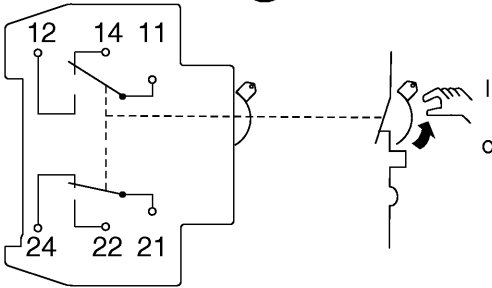

② ON/I

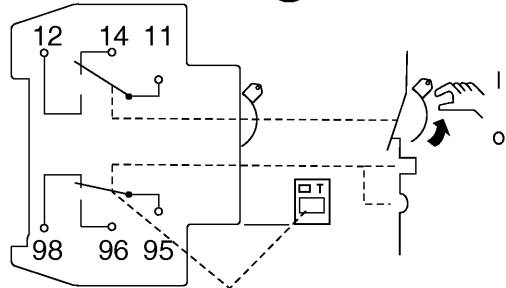

③a OFF/O

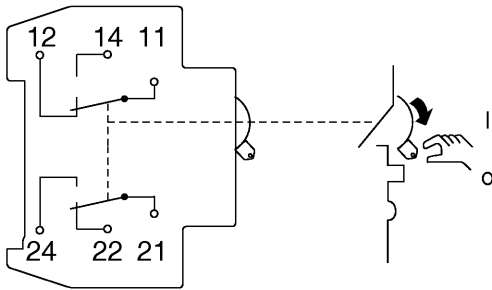

③a OFF/O

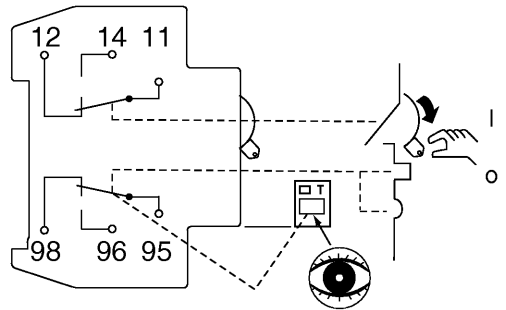

or ③b ⚡ OFF/O

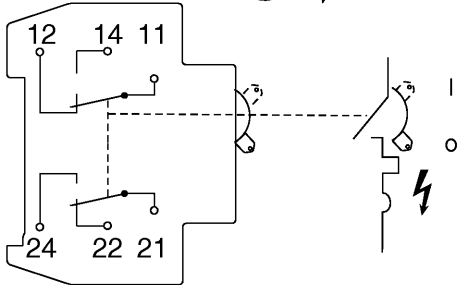

or ③b ⚡ OFF/O

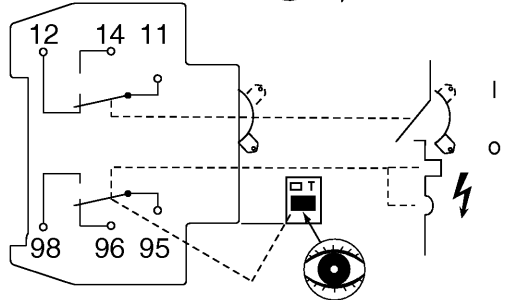

or ③c TEST OFF/O

